

Always here to help you / 始终如一地为您提供帮助

Register your product and get support at / 请登录以下网址并得到相应的帮助
www.philips.com/welcome



HC5450
HC5447
HC5446
HC3426



User manual / 用户手册

PHILIPS



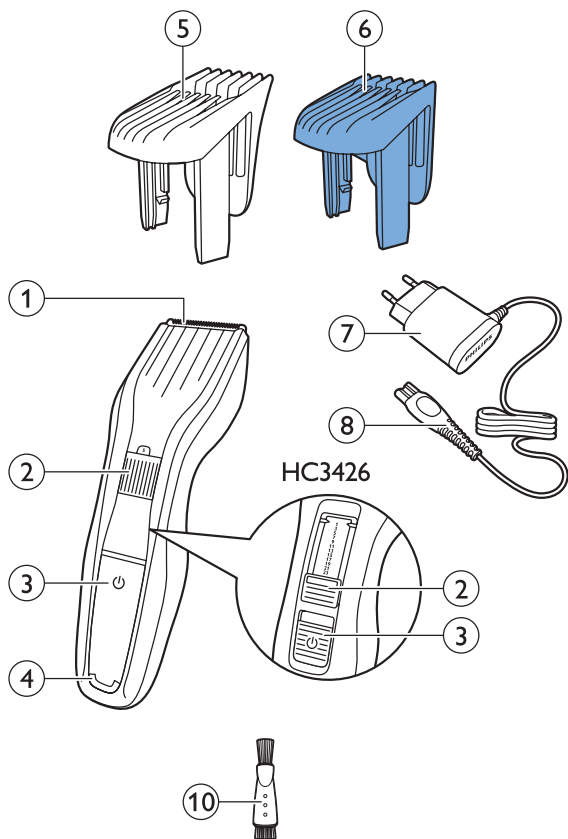



HC5450, HC5447, HC5446, HC3426

ENGLISH 6

简体中文 18

Introduction

Congratulations on your purchase and welcome to Philips! To fully benefit from the support that Philips offers, register your product at www.philips.com/welcome.

General description (Fig. 1)

- 1 Cutting unit
- 2 Length setting adjuster
- 3 On/off button
- 4 Charging light
- 5 Trimming comb
- 6 Kids comb
- 7 Adapter
- 8 Socket for small plug
- 9 Brush

Important

Read this user manual carefully before you use the appliance and save it for future reference.

Danger

- Keep the adapter dry.

Warning

- The adapter contains a transformer. Do not cut off the adapter to replace it with another plug, as this causes a hazardous situation.
- This appliance is not intended for use by persons (including children) with reduced physical, sensory or mental capabilities, or lack of experience and knowledge, unless they have been given supervision or instruction concerning use of the appliance by a person responsible for their safety.
- Children should be supervised to ensure that they do not play with the appliance.





Caution

- Never immerse the appliance in water or rinse it under the tap. Only the cutting unit can be rinsed under the tap.
- Use, charge and store the appliance at a temperature between 5°C and 35°C.
- Only use the adapter supplied.
- If the adapter is damaged, always have it replaced with one of the original type in order to avoid a hazard.
- Do not use the appliance if the cutting unit or the trimming comb is damaged or broken, as this may cause injury.

Electromagnetic fields

This Philips appliance complies with all standards and regulations regarding exposure to electromagnetic fields (EMF).

General

- The appliance is equipped with an automatic voltage selector and is suitable for mains voltages from 100 to 240 volts.
- The adapter transforms 100-240 volts to a safe low voltage of less than 24 volts.

Charging

Charge the appliance fully before you use it for the first time or after a long period of disuse.

HC5450: It takes approximately 1 hour to fully charge the appliance.

When it is fully charged, the appliance has a cordless operating time of up to 90 minutes.

HC5447, HC5446, HC3426: It takes approximately 8 hours to fully charge the appliance.

When it is fully charged, the appliance has a cordless operating time of up to 60 (HC3426) or 75 minutes (HC5446, HC5447).

Note: After charging the appliance once fully for the first time, you can also use the appliance directly from the mains. Simply connect the appliance to the mains.

Charging indications (HC5450 only)

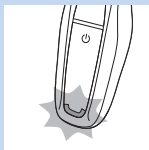

Battery low indication

- When the battery is almost empty, the charging light starts to flash orange.

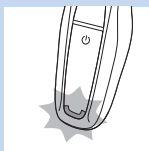

Charging

- When the appliance is charging, the charging light flashes green.

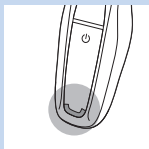

Battery fully charged

- When the battery is fully charged, the charging light lights up green continuously.

Note: After 30 minutes, the charging light automatically switches off.

Charging indications (HC5447, HC5446 and HC3426 only)

Charging

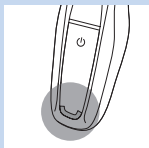

- When the appliance is charging, the charging light lights up green continuously.

Charging the appliance

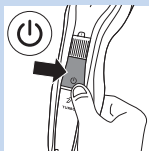

- 1 Make sure the appliance is switched off.

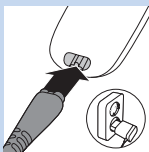

- 2 Insert the appliance plug into the appliance.
- 3 Put the adapter in the wall socket.
- 4 After charging, remove the adapter from the wall socket and pull the appliance plug out of the appliance.

Optimising the lifetime of the rechargeable battery

When you have charged the appliance for the first time, we advise you to use it until the battery is completely empty. Continue to use the appliance until the motor almost stops operating during a session. Then recharge the battery. Follow this procedure at least twice a year.

Using the appliance

The hair length settings are indicated in millimeters, the comb cuts the hair to a length of 1 mm to 23mm. The settings correspond to the remaining hair length after cutting.

When you trim for the first time, be careful.
Do not move the trimmer too fast. Make smooth and gentle movements.

Tip: Start trimming at a high length setting and reduce the length setting gradually until you have reached the desired hair length.

Trimming with comb

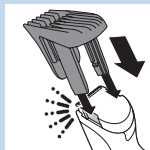

Note: The blue comb is especially for kids.

- 1 Attach the comb onto the appliance.

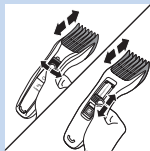

- 2 Turn the length setting adjuster to the desired length setting.

Note: When you trim for the first time, start at the highest length setting to familiarise yourself with the appliance.

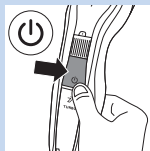

- 3 Switch on the appliance.



- 4** To trim most effectively, move the trimmer against the hair growth direction. Make sure the surface of the comb always stays in contact with the skin.

Trimming without comb

Use the trimmer without the trimming comb to clip hair close to the skin (0.5mm) or to contour the neckline and sideburns.

Be careful when you trim without comb because the cutting element removes every hair it touches.

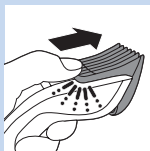

- 1** Push the comb off the appliance.

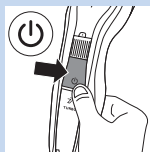

- 2** Switch on the appliance.



- 3** Make well-controlled movements. Touch the hair lightly with the trimmer.

Cleaning

Never use scouring pads, abrasive cleaning agents or aggressive liquids such as alcohol, petrol or acetone to clean the appliance.

Never immerse the appliance in water or rinse it under the tap.

Note: Only the cutting element and the comb can be cleaned with water.

- 1 Make sure the appliance is switched off and disconnected from the mains.
- 2 Wipe the housing of the appliance with a dry cloth.
- 3 Remove the comb and clean it with the brush or rinse it under the tap.

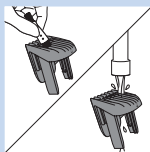

- 4 Press the release button (1). The cutting unit comes off the appliance (2).

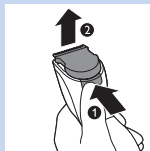

- 5 Clean the cutting unit with the brush or rinse it under the tap.

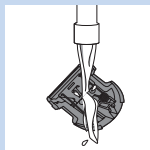



- 6** Clean the inside of the appliance with the brush.

Never immerse the appliance in water or rinse it under the tap.



- 7** Shake off excess water. To reattach the cutting unit, insert the lug of the cutting unit into the guiding slot.

- 8** Insert the lug of the cutting unit into the guiding slot (1) and push the cutting unit back onto the appliance (2).

Replacement

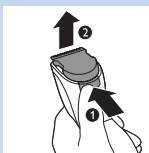

Only replace a worn or damaged cutting unit with an original Philips cutting unit, available from authorised Philips service centres.

- 1** Press the release button (1). The cutting unit comes off the appliance (2).



- 2** Insert the lug of the new cutting unit into the guiding slot (1) and push the cutting unit back onto the appliance (2).

Ordering accessories

To buy accessories or spare parts, visit **www.shop.philips.com/service** or go to your Philips dealer. You can also contact the Philips Consumer Care Centre in your country (see the worldwide guarantee leaflet for contact details).

Environment



- Do not throw away the appliance with the normal household waste at the end of its life, but hand it in at an official collection point for recycling. By doing this, you help to preserve the environment.



- The built-in rechargeable battery contains substances that may pollute the environment. Always remove the battery before you discard and hand in the appliance at an official collection point. Dispose of the battery at an official collection point for batteries. If you have trouble removing the battery, you can also take the appliance to a Philips service centre. The staff of this centre will remove the battery for you and will dispose of it in an environmentally safe way.

Removing the rechargeable battery

Only remove the rechargeable battery if it is completely empty.

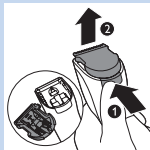

- 1** Disconnect the appliance from the mains and let the appliance operate until the motor stops.
- 2** Press the release button (1) and remove the cutting unit (2).

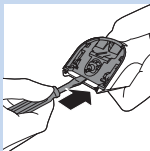

- 3** Insert the screwdriver between the motor unit and the back panel of the appliance. Press down the screwdriver as far as it will go.

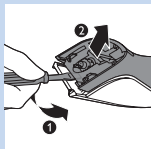

- 4 Tilt the handle of the screwdriver downwards (1) and separate the back panel from the appliance (2).

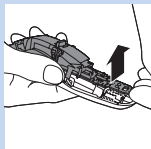

- 5 Remove the side panels. Pull the bottom part of the printed circuit board with the rechargeable batteries attached from the appliance.

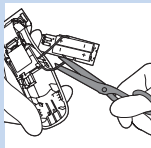

- 6 Cut the wires to separate the rechargeable batteries from the appliance.

Do not connect the appliance to the mains again after you have opened it.

Guarantee and support

If you need information or support, please visit www.philips.com/support or read the separate worldwide guarantee leaflet.

Troubleshooting

This chapter summarises the most common problems you could encounter with the appliance. If you are unable to solve the problem with the information below, visit www.philips.com/support for a list of frequently asked questions or contact the Consumer Care Centre in your country.

Problem	Possible cause	Solution
The appliance produces an uneven cutting result.	The comb does not touch the skin when you move the appliance through the hair.	Make sure the comb is always fully in contact with the skin when you move the appliance through the hair.
	You only move the appliance in one direction.	Because not all hairs grow in the same direction, move the appliance in different directions (upwards, downwards and across).
	The setting of the comb has changed during trimming.	Check the setting of the comb. If you push the appliance too hard onto the scalp, you may accidentally change the setting of the comb.
	The attachment is not assembled correctly.	Detach the attachment and reattach it.
	The cutting performance decreases when the cutting element and the comb are dirty.	Clean the cutting element and the comb (see chapter 'Cleaning and maintenance').

Problem	Possible cause	Solution
The appliance does not work when I switch it on.	The appliance has an empty battery.	Charge the appliance (see chapter 'Charging'). Make sure that the appliance plug is inserted properly into the appliance and the adapter is connected properly to the wall socket.

简介

感谢您的惠顾，欢迎光临飞利浦！
为了您能充分享受飞利浦提供的支持，请在
www.philips.com/welcome 上注册您的产品。

基本说明 (图 1)

- 1 修剪部件
- 2 长度设定调节器
- 3 开/关按钮
- 4 充电指示灯
- 5 修剪梳
- 6 儿童修剪梳
- 7 适配器
- 8 小插头的转换插座
- 9 清洁刷

注意事项

使用本产品之前，请仔细阅读本使用说明书，
并妥善保管以备日后参考。

危险

- 保持适配器干燥。

警告

- 警告符号注释：禁止用在打开的水龙头下进行清洗。
- 电源适配器内含有一个变压器。切勿自行更换插头，否则将导致严重后果。
- 器具不打算由有肢体、感官或精神能力缺陷或缺少使用经验和知识的人（包括儿童）使用，除非有负责他们安全的人对他们进行与器具使用有关的监督或指导。应照看好儿童，确保他们不玩耍本器具。”





注意

- 警告符号注释：禁止用在打开的水龙头下进行清洗。
- 切勿将本产品浸入水中或在水龙头下冲洗。仅修剪部件可在水龙头下冲洗。
- 必须在 5 摄氏度至 35 摄氏度之间的温度下使用、存放和为本产品充电。
- 只能使用随附的适配器。
- 如果适配器已损坏，则务必更换原装型号适配器，以免发生危险。
- 如果修剪部件或修理梳齿损坏或损毁，请勿再使用本产品，否则可能对人体造成伤害。

电磁场

本飞利浦产品符合所有有关暴露于电磁场 (EMF) 的标准和法规。

概述

- 本产品配有一个自动电压选择器，可使用 100 至 240 伏范围内的电源电压。
- 电源适配器可将 100-240 伏的电压转换为 24 伏以下的安全低电压。

充电

首次使用前或长时间不用之后，请为产品充满电。

HC5450：本产品充满电约需要 1 小时。

当电池充满电时，本产品可在不接电源的情况下工作长达 90 分钟。

HC5447、HC5446、HC3426：本产品充满电大约需要 8 小时。

完全充满电后，产品可无线操作达 60 分钟 (HC3426) 或 75 分钟 (HC5446、HC5447)。

注意：当首次为产品充满电后，您也可以直接插电来使用本产品。只需将产品连接到电源即可。

充电指示 (仅限于 HC5450)

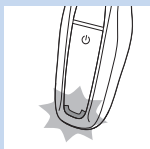

电池电量低显示灯

- 电池电量即将用尽时，充电指示灯会呈橙色闪烁。

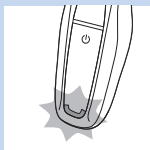

充电

- 产品充电期间，充电指示灯将呈蓝绿色闪烁。

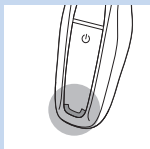

电池已完全充满

- 电池充满电时，充电指示灯将持续亮起绿灯。
- 注意：30 分钟后，充电指示灯将自动熄灭。

充电指示灯 (仅限于 HC5447、HC5446 和 HC3426)

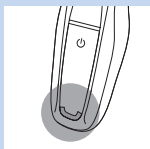

充电

- 产品充电期间，充电指示灯将呈绿色持续亮起。

为产品充电

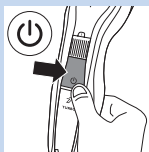

1 确保产品电源已关闭。

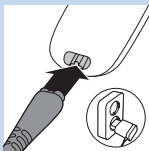

2 将产品插头插入本产品。

3 将电源适配器插入电源插座。

4 充电之后，从电源插座上拔下适配器，并从产品上拔出产品插头。

优化充电电池寿命

首次为产品充电后，建议您将产品一直使用到电池耗尽为止。一直使用本产品，直到马达在修剪过程中几乎停止运行，然后再为电池充电。每年至少两次遵循此流程。

使用本产品

须发长度设置以毫米为单位，修剪梳可将须发修剪为 1 毫米到 23 毫米之间的长度。设置对应于修剪后剩余的须发长度。

首次修剪时要特别小心。不要将修剪梳移得太快，应确保动作轻柔流畅。

提示：从较高的长度设定开始修剪，逐步减小长度设定，直至达到所需的须发长度。

修剪（有修剪梳）

注意：蓝色修剪梳特别适合儿童。

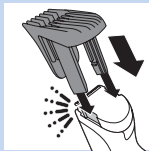

1 将修剪梳安装到本产品上。

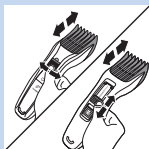

2 将长度设定调节器转到所需的长度设定。

注意：第一次修剪时，从最高的长度设定开始修剪，以熟悉产品的使用方法。

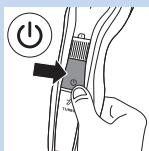

3 启动产品。



4 为进行有效的修剪，应逆着须发生长的方向移动修剪器。确保梳齿表面与皮肤保持接触。

修剪（无修剪梳）

使用不带修剪梳的修剪器以贴近皮肤的距离（0.5 毫米）修剪须发或修整颈部和鬓角的轮廓。

由于修剪部件会去除接触到的每一根头发，因此在没有梳齿修剪时要小心。

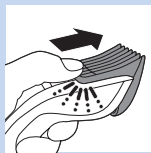

1 将修剪梳从产品中推出。

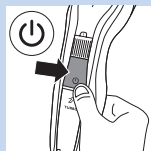

2 启动产品。



3 必须控制好产品的移动，令修剪器轻轻地接触须发。

清洁

切勿使用钢丝绒、研磨性清洁剂或腐蚀性液体（例如酒精、汽油或丙酮）来清洁产品。

切勿将本产品浸入水中，也不要自来水龙头下冲洗。

注意：只有修剪部件和修剪梳才能用清水清洗。

1 确保产品电源关闭并已将电源插头拔出。

2 使用干布擦拭产品表面。

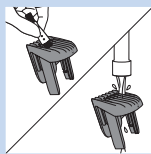

- 3** 取下修剪梳，然后用清洁刷进行清洁或放在水龙头下冲洗。

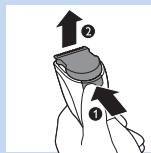

- 4** 按下释放钮 (1)。修剪部件将与产品 (2) 分离。

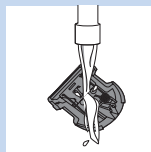

- 5** 用清洁刷清洁修剪部件或将其放在水龙头下冲洗。



- 6** 用清洁刷清洁产品内侧。

警告符号注释：禁止用在打开的水龙头下进行清洗。

切勿将本产品浸入水中，也不要在自来水龙头下冲洗。



- 7** 甩掉多余的水份。要重新装回修剪部件，请将修剪部件的凸缘插入导向槽。

- 8** 将修剪部件的凸缘插入导向槽 (1) 内，然后将修剪部件推回产品 (2)。

更换

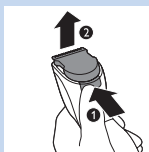

- 1 按下释放钮 (1)。修剪部件将与产品 (2) 分离。



- 2 将新修剪部件的凸缘插入导向槽 (1) 内，然后将修剪部件推回产品 (2)。

订购附件

要购买附件和备件，请访问
www.shop.philips.com/service

或 请联系飞利浦经销商。您也可以联系您所在国家/地区的飞利浦客户服务中心（联系详情，请参阅全球保修卡）。

环保



- 弃置产品时，请不要将其与一般生活垃圾堆放在一起；应将其交给官方指定的回收点。这样做有利于环保。



- 内置充电电池含有可能会污染环境的物质。丢弃产品时，一定要将电池取出，并将产品送到官方指定的回收站。到官方指定的电池回收站处理电池。如果您在取出电池时遇到问题，您也可以将产品送至飞利浦维修中心。维修中心的员工会帮您取出电池，并以环保的方式处理它。

卸下充电电池

电池电量完全耗尽后方可取出充电电池。

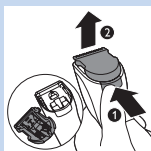

- 1 断开产品电源并让产品继续运行，直到马达停止。
- 2 按下释放钮 (1)，取下修剪部件 (2)。

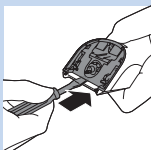

- 3 将螺丝刀插在马达装置和产品后面板之间。尽量向下按压螺丝刀

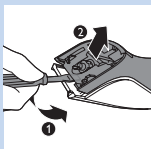

- 4 向下倾斜螺丝刀杆 (1)，然后使后面板与产品 (2) 分离。

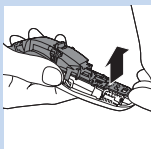

- 5 取下侧面板。从产品中拉出装有充电电池的印刷电路板的下半部分。

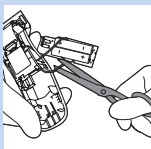

- 6 剪断电线以将充电电池从产品上分开。一旦打开产品，请勿再将其与电源相连。

保修和支持

如果您需要信息或支持，请访问 www.philips.com/support 或阅读单独的全球保修卡。

故障种类和处理方法

本章归纳了使用本产品时最常见的一些问题。如果您无法根据以下信息解决问题，请访问 www.philips.com/support 查阅常见问题列表，或联系您所在国家/地区的客户服务中心。

问题	可能的原因	解决方法
理发器的修剪效果不均匀。	产品在头发上推动时没有触碰头皮。	修剪梳在头发上推动时，请确保修剪梳可始终与皮肤完全接触。
	您只向一个方向移动产品。	由于并非所有头发都向一个方向生长，请向不同方向移动产品（向上、向下以及交叉）。
	修剪过程中修剪梳的设置有所更改。	检查修剪梳的设置。如果您将产品过于用力地按在头皮上，您可能会意外更改修剪梳的设置。
	附件安装不正确。	拆下附件，然后重新安装。
	如果修剪部件和修剪梳不干净，修剪性能会下降。	清洁修剪部件和修剪梳（见“清洁和保养”一章）。
启动产品后，产品无法工作。	产品电池电量耗尽。	为产品充电（见“充电”一章）。请确保产品的插头已正确插入产品，并且适配器已正确连接至电源插座。

本产品（同一型号）所配备的电源适配器有2种规格，请以实物为准。

PHILIPS

产品 : 飞利浦家庭理发器
型号 : HC3426
额定电压 : 220V~
额定频率 : 50Hz
额定输入功率: 7.5 W
生产日期 : 请见产品本体
产地 : 印度尼西亚

IPX4



飞利浦电子香港有限公司
香港新界沙田香港科学园科技道东五号

经销单位: 飞利浦(中国)投资有限公司
上海市天目西路218号1602-1605
全国顾客服务热线: 4008 800 008

本产品根据国标 GB4706.1-2005, GB4706.9-2008制造

PHILIPS

产品 : 飞利浦家庭理发器
型号 : HC3426
额定电压 : 220V~
额定频率 : 50Hz
额定输入功率: 9 W
生产日期 : 请见产品本体
产地 : 印度尼西亚

IPX4



飞利浦电子香港有限公司
香港新界沙田香港科学园科技道东五号

经销单位: 飞利浦(中国)投资有限公司
上海市天目西路218号1602-1605
全国顾客服务热线: 4008 800 008

本产品根据国标 GB4706.1-2005, GB4706.9-2008制造

PHILIPS

产品 : 飞利浦家庭理发器
 型号 : HC5446
 额定电压 : 220V~
 额定频率 : 50Hz
 额定输入功率: 7.5 W
 生产日期 : 请见产品本体
 产地 : 印度尼西亚

IPX4



飞利浦电子香港有限公司
 香港新界沙田香港科学园科技道东五号

经销单位: 飞利浦 (中国) 投资有限公司
 上海市天目西路218号1602-1605
 全国顾客服务热线: 4008 800 008

本产品根据国标 GB4706.1-2005, GB4706.9-2008制造

PHILIPS

产品 : 飞利浦家庭理发器
 型号 : HC5446
 额定电压 : 220V~
 额定频率 : 50Hz
 额定输入功率: 9 W
 生产日期 : 请见产品本体
 产地 : 印度尼西亚

IPX4



飞利浦电子香港有限公司
 香港新界沙田香港科学园科技道东五号

经销单位: 飞利浦 (中国) 投资有限公司
 上海市天目西路218号1602-1605
 全国顾客服务热线: 4008 800 008

本产品根据国标 GB4706.1-2005, GB4706.9-2008制造

PHILIPS

产品 : 飞利浦家庭理发器
型号 : HC5447
额定电压 : 220V~
额定频率 : 50Hz
额定输入功率: 7.5 W
生产日期 : 请见产品本体
产地 : 印度尼西亚

IPX4



飞利浦电子香港有限公司
香港新界沙田香港科学园科技道东五号

经销单位: 飞利浦 (中国) 投资有限公司
上海市天目西路218号1602-1605
全国顾客服务热线: 4008 800 008

本产品根据国标 GB4706.1-2005, GB4706.9-2008制造

PHILIPS

产品 : 飞利浦家庭理发器
型号 : HC5447
额定电压 : 220V~
额定频率 : 50Hz
额定输入功率: 9 W
生产日期 : 请见产品本体
产地 : 印度尼西亚

IPX4



飞利浦电子香港有限公司
香港新界沙田香港科学园科技道东五号

经销单位: 飞利浦 (中国) 投资有限公司
上海市天目西路218号1602-1605
全国顾客服务热线: 4008 800 008

本产品根据国标 GB4706.1-2005, GB4706.9-2008制造

PHILIPS

产品 : 飞利浦家庭理发器
 型号 : HC5450
 额定电压 : 220V~
 额定频率 : 50Hz
 额定输入功率: 7.5 W
 生产日期 : 请见产品本体
 产地 : 印度尼西亚

IPX4



飞利浦电子香港有限公司
 香港新界沙田香港科学园科技道东五号

经销单位: 飞利浦(中国)投资有限公司
 上海市天目西路218号1602-1605
 全国顾客服务热线: 4008 800 008

本产品根据国标 GB4706.1-2005, GB4706.9-2008制造

PHILIPS

产品 : 飞利浦家庭理发器
 型号 : HC5450
 额定电压 : 220V~
 额定频率 : 50Hz
 额定输入功率: 9 W
 生产日期 : 请见产品本体
 产地 : 印度尼西亚

IPX4



飞利浦电子香港有限公司
 香港新界沙田香港科学园科技道东五号

经销单位: 飞利浦(中国)投资有限公司
 上海市天目西路218号1602-1605
 全国顾客服务热线: 4008 800 008

本产品根据国标 GB4706.1-2005, GB4706.9-2008制造

请妥善保管本使用说明书

发行日期: 23/01/2014







www.philips.com



100% recycled paper
100% 循环再造纸

4222.002.8463.1