

Register your product and get support at  
[www.philips.com/welcome](http://www.philips.com/welcome)

HTS3510  
HTS3520



**PHILIPS**



# Contents

<b>1 Notice</b>	2
Copyright	2
Compliance	2
Mains fuse (UK only)	2
Trademarks	2
<b>2 Important</b>	3
Safety	3
Product care	3
Disposal of your old product and batteries	4
<b>3 Your home theatre</b>	4
Main unit	4
Remote control	5
<b>4 Connect your home theatre</b>	6
Connectors	6
Connect to the TV	7
Connect audio from TV or other devices	8
<b>5 Use your home theatre</b>	8
Before you start	8
Choose your sound	8
Play a disc	9
Play from a USB storage device	10
More play features	11
Play from radio	11
Play audio from TV or other devices	11
Create MP3 audio files	12
<b>6 Change settings</b>	12
Change general settings	13
Change audio settings	13
Change video settings	13
Change preference settings	14
<b>7 Update software</b>	14
Check software version	14
Update software from a CD-R or USB	14
<b>8 Product specifications</b>	15

<b>9 Troubleshooting</b>	16
--------------------------	----

<b>10 Index</b>	17
-----------------	----

# 1 Notice

## Copyright



This product incorporates copyright protection technology that is protected by method claims of certain U.S. patents and other intellectual property rights owned by Macrovision Corporation and other rights owners. Use of this copyright protection technology must be authorised by Macrovision Corporation, and is intended for home and other limited viewing uses only unless otherwise authorised by Macrovision Corporation. Reverse engineering or disassembly is prohibited.

### Copyright in the UK

Recording and playback of material may require consent. See Copyright Act 1956 and The Performers' Protection Acts 1958 to 1972.

## Compliance



This product is in compliance with the essential requirements and other relevant provisions of Directives 2006/95/EC (Low Voltage) and 2004/108/EC (EMC).

### Mains fuse (UK only)

This product is fitted with an approved moulded plug. Should it become necessary to replace the mains fuse, this must be replaced with a fuse of the same value as indicated on the plug (example 10A).

- 1 Remove fuse cover and fuse.
- 2 The replacement fuse must comply with BS 1362 and have the ASTA approval mark. If the fuse is lost, contact your dealer in order to verify the correct type.
- 3 Refit the fuse cover.

### Note

- To conform to the EMC directive (2004/108/EC), the mains plug on this product must not be detached from the mains cord.

## Trademarks



Manufactured under license from Dolby Laboratories. Dolby, Pro Logic and the double-D symbol are trademarks of Dolby Laboratories.



Windows Media and the Windows logo are trademarks, or registered trademarks of Microsoft Corporation in the United States and/or other countries.



HDMI, the HDMI logo and High-Definition Multimedia Interface are trademarks or registered trademarks of HDMI Licensing LLC.



The USB-IF Logos are trademarks of Universal Serial Bus Implementers Forum, inc.



## 2 Important

Read and understand all instructions before you use your home theatre. If damage is caused by failure to follow instructions, the warranty does not apply.

### Safety

#### Risk of electric shock or fire!

- Never expose the product and accessories to rain or water. Never place liquid containers, such as vases, near the product. If liquids are spilt on or into the product, disconnect it from the power socket immediately. Contact Philips Consumer Care to have the product checked before use.
- Never place the product and accessories near naked flames or other heat sources, including direct sunlight.
- Never insert objects into the ventilation slots or other openings on the product.
- Where the mains plug or an appliance coupler is used as the disconnect device, the disconnect device shall remain readily operable.
- Disconnect the product from the power socket before lightning storms.
- When you disconnect the power cord, always pull the plug, never the cable.

#### Risk of short circuit or fire!

- Before you connect the product to the power socket, ensure that the power voltage matches the value printed on the back or bottom of the product. Never connect the product to the power socket if the voltage is different.

#### Risk of injury or damage to the home theatre!

- For wall-mountable products, use only the supplied wall mount bracket. Secure the wall mount to a wall that can support the combined weight of the product and the wall mount. Koninklijke Philips Electronics N.V. bears no responsibility for improper wall mounting that results in accident, injury or damage.
- For speakers with stands, use only the supplied stands. Secure the stands to the speakers tightly. Place the assembled stands on flat, level surfaces that can support the combined weight of the speaker and stand.

- Never place the product or any objects on power cords or on other electrical equipment.
- If the product is transported in temperatures below 5°C, unpack the product and wait until its temperature matches room temperature before connecting it to the power socket.
- Visible and invisible laser radiation when open. Avoid exposure to the beam.
- Do not touch the disc optical lens inside the disc compartment.

#### Risk of overheating!

- Never install this product in a confined space. Always leave a space of at least four inches around the product for ventilation. Ensure curtains or other objects never cover the ventilation slots on the product.

#### Risk of contamination!

- Do not mix batteries (old and new or carbon and alkaline, etc.).
- Remove batteries if they are exhausted or if the remote control is not to be used for a long time.
- Batteries contain chemical substances, they should be disposed of properly.

### Product care

- Do not insert any objects other than discs into the disc compartment.
- Do not insert warped or cracked discs into the disc compartment.
- Remove discs from the disc compartment if you are not using the product for an extended period of time.
- Only use microfibre cloth to clean the product.

## Disposal of your old product and batteries



Your product is designed and manufactured with high quality materials and components, which can be recycled and reused.



When this crossed-out wheeled bin symbol is attached to a product it means that the product is covered by the European Directive 2002/96/EC. Please inform yourself about the local separate collection system for electrical and electronic products.

Please act according to your local rules and do not dispose of your old products with your normal household waste.

Correct disposal of your old product helps to prevent potential negative consequences for the environment and human health.



Your product contains batteries covered by the European Directive 2006/66/EC, which cannot be disposed with normal household waste.

Please inform yourself about the local rules on separate collection of batteries because correct disposal helps to prevent negative consequences for the environmental and human health.

## 3 Your home theatre

Congratulations on your purchase, and welcome to Philips! To fully benefit from the support that Philips offers, register your home theatre at [www.philips.com/welcome](http://www.philips.com/welcome).

### Main unit

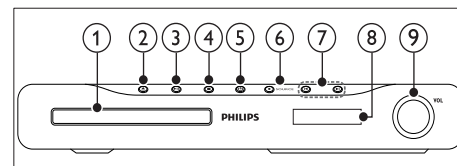

- ① **Disc compartment**
- ② **▲ (Open/Close)**  
Opens or closes the disc compartment.
- ③ **▶ II (Play/Pause)**  
Starts, pauses or resumes play.
- ④ **■ (Stop)**
  - Stops play.
  - In radio mode, erases the current preset radio station.
- ⑤ **⏻ (Standby-On)**  
Switches the home theatre on or to standby.
- ⑥ **SOURCE**  
Selects an audio/video source for the home theatre.
- ⑦ **⏮ / ⏭**
  - Skips to the previous or next track, chapter or file.
  - In radio mode, selects a preset radio station.
- ⑧ **Display panel**
- ⑨ **Volume control wheel**

## Remote control

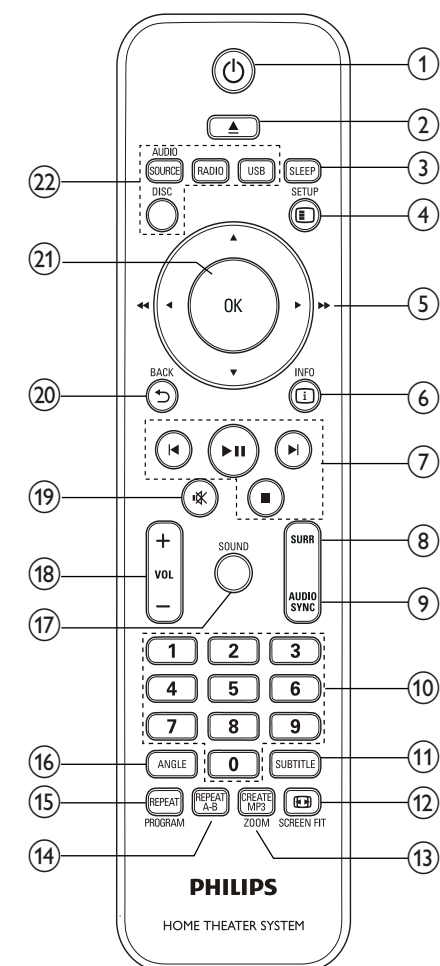

- ① **⏻ (Standby-On)**  
Switches the home theatre on or to standby.
- ② **⬆️ OPEN/CLOSE**  
Opens or closes the disc compartment.
- ③ **SLEEP**  
Switches the home theatre to standby after the preset time selected.
- ④ **⚙️ SETUP**  
Accesses or exits the setup menu.

- ⑤ **⬅️➡️⬆️⬆️⬆️ (Navigation buttons)**
- Navigate menus.
  - In video mode, press left or right to fast backward or fast forward.
  - In radio mode, press left or right to search for a radio station; press up or down to fine tune a radio frequency.
- ⑥ **ℹ️ INFO**  
Displays information about what is playing.
- ⑦ **Playback buttons**  
Control playback.
- ⑧ **SURR (Surround Sound)**  
Switches to surround sound or stereo sound.
- ⑨ **AUDIO SYNC**
- Selects an audio language or channel.
  - Press and hold to synchronise audio with video. Use with +/-.
- ⑩ **Numeric buttons**  
Selects an item to play.
- ⑪ **SUBTITLE**  
Selects subtitle language for video.
- ⑫ **📺 SCREEN FIT**  
Fits the picture format to the TV screen.
- ⑬ **CREATE MP3/ZOOM**
- Accesses the menu to create MP3.
  - Zooms into a video scene or picture.
- ⑭ **REPEAT A-B**  
Marks two points within a chapter or track for repeat play, or turns off repeat mode.
- ⑮ **REPEAT / PROGRAM**
- Selects a repeat or shuffle mode.
  - In radio mode, programmes radio stations.
- ⑯ **ANGLE**  
Displays options for different camera angles.
- ⑰ **SOUND**  
Selects a sound mode.
- ⑱ **VOL +/-**  
Increases or decreases volume.
- ⑲ **🔇 (Mute)**  
Mutes or restores volume.
- ⑳ **⏮️ BACK**  
Returns to a previous menu screen.

- ②① **OK**  
Confirms an entry or selection.
- ②② **Source buttons**
  - **AUDIO SOURCE:** Selects an audio input source.
  - **RADIO:** Switches to FM radio.
  - **USB:** Switches to USB storage device.
  - **DISC:** Switches to disc source.

## 4 Connect your home theatre

This section helps you connect your home theatre to a TV and other devices. The basic connections of the home theatre with its accessories are provided in the Quick Start. For a comprehensive interactive guide, see [www.connectivityguide.philips.com](http://www.connectivityguide.philips.com).

### Note

- Refer to the type plate at the back or bottom of the product for identification and supply ratings.
- Before you make or change any connections, ensure that all devices are disconnected from the socket.

## Connectors

### Side connectors

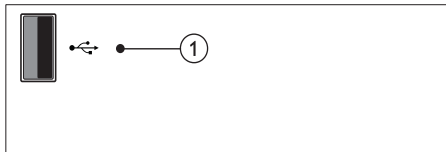

- ① **USB**  
Audio, video or picture input from a USB storage device.

### Back connectors

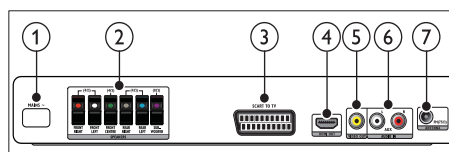

- ① **AC MAINS~**  
Connects to the power supply.
- ② **SPEAKERS**  
Connects to the supplied speakers and subwoofer.
- ③ **SCART TO TV**  
Connects to the scart input on the TV.



- ④ **HDMI OUT**  
Connects to the HDMI input on the TV.
- ⑤ **VIDEO OUT**  
Connects to the composite video input on the TV.
- ⑥ **AUDIO IN-AUX**  
Connects to the analogue audio output on the TV or an analogue device.
- ⑦ **FM ANTENNA FM 75Ω**  
Connects the FM antenna for radio reception.

## Connect to the TV

Connect your home theatre directly to a TV through one of the following connectors (from highest to basic quality video):

- ① **HDMI**
- ② **Scart**
- ③ **Composite video**

### Option 1: Connect to the TV through HDMI

#### Note

- If the HDTV has a DVI connector, connect using an HDMI/DVI adapter.

(Cable not supplied)

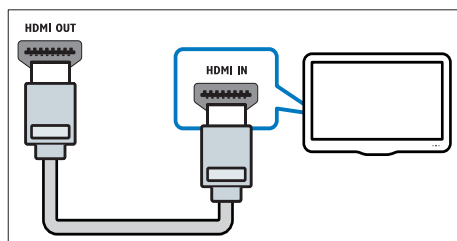

### Option 2: Connect to the TV through Scart

(Cable not supplied)

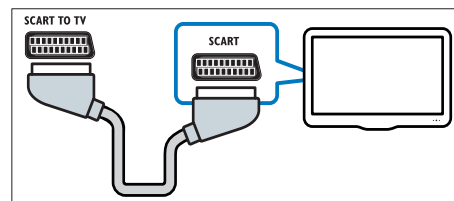

### Option 3: Connect to the TV through composite video (CVBS)

#### Note

- The composite video cable or connector might be labelled **AV IN**, **VIDEO IN**, **COMPOSITE** or **BASEBAND**.

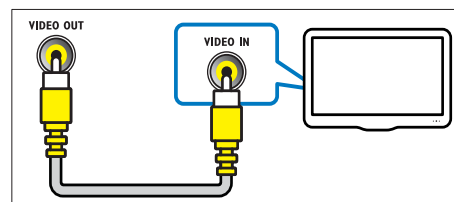

## Connect audio from TV or other devices

Use your home theatre to play audio from the TV or another device such as a cable box.



Tip

- Press **AUDIO SOURCE** to select the audio output of your connection.

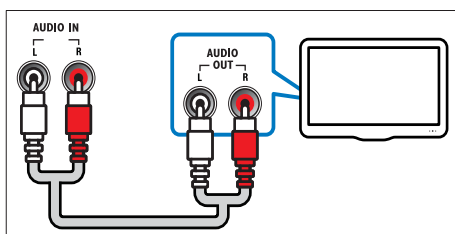

## 5 Use your home theatre

This section helps you use the home theatre to play media from a wide range of sources.

### Before you start

Make sure that you:

- Make the necessary connections and complete the setup as described in the Quick Start.
- Switch the TV to the correct source for the home theatre.

### Choose your sound

This section helps you choose the ideal sound for your video or music.

#### Change sound mode

Select predefined sound modes to suit your video or music.

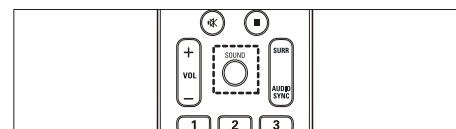

Press **SOUND** repeatedly to cycle through the available sound modes.

Sound mode	Description
<b>ACTION / ROCK</b>	Enhanced low and high-range. Ideal for action movies and rock or pop music.
<b>DRAMA / JAZZ</b>	Clear mid and high-range. Ideal for drama movies and jazz music.
<b>CONCERT/ CLASSIC</b>	Neutral sound. Ideal for live concerts and classical music.
<b>SPORTS</b>	Moderate mid-range and surround effects for clear vocals and the atmosphere of a live sport venue.
<b>NIGHT</b>	Dynamically controlled sound mode suitable for watching movies at night or for non-intrusive background music.

Change surround sound mode

Experience an immersive audio experience with surround sound modes.

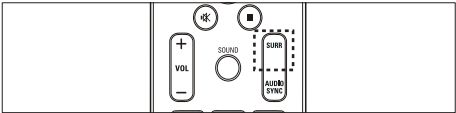

Press **SURR** repeatedly to cycle through the available surround modes.

Option	Description
<b>MULTI-CHANNEL</b>	Immersive multi-channel sound for an enhanced movie experience.
<b>STEREO</b>	Two-channel stereo sound. Ideal for listening to music.

Play a disc

The home theatre can play a wide variety of discs, including video, audio and mixed media (for example, a CD-R that contains JPEG pictures and MP3 music).

- 1 Insert a disc into the home theatre.
- 2 Press **DISC**.
  - The disc plays or the disc main menu appears.
- 3 Press the following buttons to control play:

Button	Action
<b>Navigation buttons</b>	Navigate menus.
<b>OK</b>	Confirms an entry or selection.
<b>▶  </b>	Starts, pauses or resumes play.
<b>■</b>	Stops play.
<b>◀/▶</b>	Skips to the previous or next track, chapter or file.
<b>◀◀/▶▶</b>	Fast backwards or fast forwards. Press repeatedly to change the search speed. In pause mode, steps forward by one frame.
<b>ZOOM</b>	Zooms into a video scene or picture.
<b>REPEAT A-B</b>	Marks two points within a chapter or track for repeat play, or turns off repeat mode.
<b>SCREEN FIT</b>	Fits the picture format to the TV screen.

## Use video options

Access several useful features while viewing video.

### Note

- Available video options depend on the video source.

Button	Action
▲ / ▼	Searches slow-backwards or slow-forwards. Press repeatedly to change the search speed. For VCD/SVCD, slow-backwards search is not available.
AUDIO SYNC	Selects an audio language or channel.
SUBTITLE	Selects subtitle language for video.
ⓘ INFO	Displays information about what is playing.
REPEAT	Repeats a chapter or title.
ANGLE	Displays options for different camera angles.

## Use picture options

Access several useful features while viewing pictures.

Button	Action
▲ / ▼	Rotates the picture anti-clockwise or clockwise.
◀ / ▶	Skips to the previous or next picture.
REPEAT	Repeats a single file in the folder or repeats the entire folder. Shuffle files in a folder.
ⓘ INFO	Displays photo albums in a thumbnail overview.

## Use audio options

Access several useful features while audio is played.

Button	Action
REPEAT	Repeats a track, the entire disc or shuffle tracks.

## Play from a USB storage device

The home theatre is fitted with a USB connector that allows you to view pictures, listen to music or watch movies stored on a USB storage device.

- 1 Connect the USB storage device to the home theatre.
- 2 Press **USB**.  
↳ A content browser appears.
- 3 Select a file, then press **OK**.
- 4 Press the playback buttons to control play (see 'Play a disc' on page 9).

### Note

- If the USB storage device does not fit into the connector, use a USB extension cable.
- The home theatre does not support digital cameras that need a computer program to display photos.
- The USB storage device must be FAT or DOS-formatted, and Mass Storage Class compliant.

## More play features

Several advanced features are available for video or picture playback from a disc or USB storage device.

### Play a musical slideshow

Play music and pictures simultaneously to create a musical slideshow. The files must be stored on the same disc or USB storage device.

- 1 Select a music track, then press **OK**.
- 2 Press **↩ BACK** and go to the picture folder.
- 3 Select a picture, then press **OK** to start slideshow.
- 4 Press **■** to stop slideshow.
- 5 Press **■** again to stop music.

### Synchronise audio with video

If the audio and video are not synchronized, you can delay the audio to match the video.

- 1 Press and hold **AUDIO SYNC** until the audio sync message appears on the display panel.
- 2 Press **+/-** within five seconds to sync the audio with your video.

### Quick skip play to a specific time

Quick skip to a specific part of a video by entering the time of a scene.

- 1 During video play, press **ⓘ INFO**.
- 2 Press the **Navigation buttons** and **OK** to select:
  - **[TT Time]** : Title time.
  - **[Ch Time]** : Chapter time.
  - **[Disc Time]** : Disc time.
  - **[Track Time]** : Track time.
- 3 Enter the time of the scene, then press **OK**.

## Play from radio

The home theatre can store up to 40 radio stations.

- 1 Check that the FM antenna is connected.
- 2 Press **RADIO**.
  - ↳ "AUTO INSTALL...PRESS PLAY" appears on the display panel if you have not installed any radio stations. Press **▶▶**.
- 3 Press the following buttons to control play:

Button	Action
<b>◀ / ▶</b>	Selects a preset radio station.
<b>◀◀ / ▶▶</b>	Searches for a radio station.
<b>▲▼</b>	Fine tunes a radio frequency.
<b>■</b>	Press and hold to erase the preset radio station. Press to stop the installation of radio stations.

**PROGRAM** Manual: Press once to access programme mode, and press again to store the radio station. Automatic: Press and hold for five seconds to reinstall radio stations.

### Note

- AM and digital radio are not supported.
- If no stereo signal is detected, or if fewer than five stations are found, you are prompted to install the radio stations again.
- For the best reception, place the antenna away from the TV or other sources of radiation.

## Play audio from TV or other devices

Press **AUDIO SOURCE** repeatedly to select the audio output of the connected device.

## Create MP3 audio files

Use the home theatre to convert audio CDs into MP3 audio files.

- 1 Insert an audio CD (CDDA/HDCD) into the home theatre.
- 2 Connect a USB storage device to the home theatre.
- 3 When audio is played, press **CREATE MP3**.

CREATE MP3			
OPTIONS		TRACK	
Speed	Normal	<input type="radio"/> Track01	04:14
Bitrate	128kbps	<input type="radio"/> Track02	04:17
		<input type="radio"/> Track03	03:58
		<input type="radio"/> Track04	04:51
		<input type="radio"/> Track05	03:53
		<input type="radio"/> Track06	04:09
		<input type="radio"/> Track07	04:38
SUMMARY			
Select Track	0		
Time	00:00		
Start	Exit	Select All	Deselect All

- 4 Select the conversion settings in the [OPTIONS] panel, then press **OK**.
  - **[Speed]** : Selects the write-to-file speed.
  - **[Bitrate]** : Selects the conversion quality.
- 5 Press **▶** to access the [TRACK] panel.
- 6 Select an audio track, then press **OK**.
  - **[Select All]** : Selects all tracks.
  - **[Deselect all]** : De-selects all tracks.
- 7 Select **[Start]** in the menu to convert, then press **OK**.
  - ↳ A new folder is created in the USB storage device to store all the new MP3 audio files.
  - To exit the menu, select **[Exit]** and press **OK**.

### Note

- During the conversion process, do not press any buttons.
- DTS CDs and copy-protected CDs cannot be converted.
- A write-protected or password-protected USB storage device cannot be used to store MP3 files.





## 6 Change settings

This section helps you to change the settings of your home theatre.

### Caution

- Many of the settings are already configured with the best value for the home theatre. Unless you have a specific reason to change a setting, it is best to leave it at the default value.

- 1 Press **⏏** **SETUP**.
  - ↳ The following menu appears.

Symbol	Description
	[General Setup]
	[Audio Setup]
	[Video Setup]
	[Preference Setup]

- 2 Select a setup menu, then press **OK**.  
See the following sections for information about how to change the settings of your home theatre.
- 3 Press **⏏** **BACK** to return to the previous menu, or press **⏏** **SETUP** to exit.

### Note

- You cannot change a setting that is greyed out.

## Change general settings

- 1 Press  **SETUP**.
- 2 Select **[General Setup]**, then press **OK**.
- 3 Select and adjust the following settings:
  - **[Disc Lock]** : Restricts play to disc. Password (PIN code) is required to unlock the disc before play.
  - **[Display Dim]** : Changes the brightness of the display panel.
  - **[OSD Language]** : Selects the on-screen display menu language.
  - **[Screen Saver]** : Enables or disables screen saver mode. If enabled, the screen enters idle mode after 10 minutes of inactivity (for example, in pause or stop mode).
  - **[Sleep Timer]** : Sets a sleep timer to switch the home theatre to standby after a specific time.
  - **[Auto Standby]** : Enables or disables auto standby. If enabled, the home theatre switches to standby after 30 minutes of inactivity (for example, in pause or stop mode).
- 4 Press **OK** to confirm your choice.

## Change audio settings

- 1 Press  **SETUP**.
- 2 Select **[Audio Setup]**, then press **OK**.
- 3 Select and adjust the following settings:
  - **[Speakers Volume]** : Sets the volume of each speaker to obtain the ideal audio balance.
  - **[Speakers Delay]** : Sets the delay time for centre and rear speakers to obtain an equal audio transmission from all the speakers.
  - **[HDMI Audio]** : Enables or disables HDMI audio output for the TV.
  - **[Audio Sync]** : Sets a delay for audio output when you play a video disc.
- 4 Press **OK** to confirm your choice.

### Note

- For settings related to HDMI, the TV must be connected through HDMI.

## Change video settings

- 1 Press  **SETUP**.
- 2 Select **[Video Setup]**, then press **OK**.
- 3 Select and adjust the following settings:
  - **[TV System]** : Selects a TV system that is compatible with the TV.
  - **[TV Display]** : Selects a picture display format to fit the TV screen.
  - **[Picture Settings]** : Selects a predefined colour setting.
  - **[HDMI Setup]** : Selects HDMI video resolution and the wide screen display format for the TV. The Wide Screen Display option is only available for the 16:9 wide screen TV display setting.
  - **[HD JPEG]** : Enables or disables display of high definition JPEG images.
- 4 Press **OK** to confirm your choice.

### Note

- The best setting is automatically selected for the TV. If you need to change the setting, ensure that the TV supports the new setting.
- Some video settings depend on the video source, ensure that the disc and the TV support the setting or feature.
- For settings related to HDMI, the TV must be connected through HDMI.

---

## Change preference settings

- 1 Press  **SETUP**.
- 2 Select **[Preference Setup]**, then press **OK**.
- 3 Select and adjust the following settings:
  - **[Audio]** : Selects audio language for video.
  - **[Subtitle]** : Selects subtitle language for video.
  - **[Disc Menu]** : Selects menu language for video disc.
  - **[Parental]** : Restricts access to discs that are recorded with ratings. To play all discs irrespective of the rating, select level '8'.
  - **[PBC]** : Displays or skips the content menu for VCD and SVCD discs.
  - **[MP3/JPEG Display]** : Displays the MP3/JPEG folders or all the files.
  - **[Password]** : Sets or changes a PIN code to play a restricted disc. Enter '0000' if you do not have a PIN or if you have forgotten your PIN.
  - **[Version Info.]** : Displays the software version for the home theatre.
  - **[Default]** : Resets the home theatre to the default settings programmed at the factory.
- 4 Press **OK** to confirm your choice.

### Note

- If you select a language that is not available on a disc, the home theatre uses the default language of the disc.
- You cannot reset disc lock, password (PIN code) and parental control settings to their default values.

## 7 Update software

To check for new updates, compare the current software version of your home theatre with the latest software version (if available) on the Philips website.

---

### Check software version

- 1 Press  **SETUP**.
- 2 Select **[Preference Setup]** > **[Version Info.]**, then press **OK**.
  - ↳ The software version is displayed.

---

### Update software from a CD-R or USB

- 1 Check for the latest software version on [www.philips.com/support](http://www.philips.com/support).
  - Search for your model and click on 'software&drivers'.
- 2 Download the software onto a CD-R or USB storage device.
- 3 Insert the CD-R or connect the USB storage device to the home theatre.
- 4 Follow the instructions on the TV to confirm the update.
  - ↳ When the update is complete, the home theatre automatically switches to standby.
- 5 Disconnect the power cord for a few seconds and then reconnect it.

### Caution

- Do not turn off the power or remove the CD-R or USB storage device when the software update is in progress because you might damage the home theatre.



## 8 Product specifications

### Note

- Specification and design are subject to change without notice.

### Region code

Country	DVD
Europe, United Kingdom	
Asia Pacific, Taiwan, Korea	
Latin America	
Australia, New Zealand	
Russia, India	
China	

### Playback media

DVD-Video, DVD+R/+RW, DVD-R/-RW, DVD+R DL, CD-R/CD-RW, Audio CD, Video CD/SVCD, Picture CD, MP3-CD, WMA-CD, USB storage device

### File Format

- Audio: .mp3, .wma
- Video: .mpeg, .mpg
- Picture: .jpeg, .jpg

### Amplifier

- Total output power:
  - HTS3510: 300 W RMS
  - HTS3520: 600 W RMS
- Frequency response: 20 Hz-20 kHz/±3 dB
- Signal-to-noise ratio: > 65 dB (CCIR)/(A-weighted)
- Input sensitivity:
  - AUX: 1 mV

### Video

- Signal system: PAL/NTSC
- HDMI output: 480i/576i, 480p/576p, 720p, 1080i, 1080p

### Audio

- Sampling frequency:
  - MP3: 32 kHz, 44.1 kHz, 48 kHz
  - WMA: 44.1 kHz, 48 kHz
- Constant bit rate:
  - MP3: 112 kbps - 320 kbps
  - WMA: 48 kbps - 192 kbps

### Radio

- Tuning range: FM 87.5-108 MHz (50 kHz)
- Signal-to-noise ratio: FM 50 dB
- Frequency response: FM 180 Hz-10 kHz/±6 dB

### USB

- Compatibility: Hi-Speed USB (2.0)
- Class support: UMS (USB Mass Storage Class)
- File system: FAT12, FAT16, FAT32
- Maximum memory support: < 160 GB.

### Main Unit

- Power supply: 220-240V; ~50 Hz
- Power consumption: 100 W
- Standby power consumption: < 0.9 W
- Dimensions (WxHxD): 360 x 58 x 320 (mm)
- Weight: 2.84 kg

### Subwoofer

- Impedance: 8 ohm
- Speaker drivers: 165 mm (6.5") woofer
- Frequency response: 40 Hz-150 kHz
- Dimensions (WxHxD): 120 x 307 x 369 (mm)
- Weight: 3.84 kg
- Cable length: 4.3 m

### Speakers

- System: full range satellite
- Speaker impedance: 8 ohm (Centre), 4 ohm (Front/Rear)
- Speaker drivers: 3" full range
- Frequency response: 150 Hz-20 kHz
- Dimensions (W x H x D):
  - HTS3510: 96 x 162 x 96 (mm)
  - HTS3520:
    - Centre: 160.9 x 95 x 92 (mm)
    - Front/Rear: 95 x 160.9 x 87 (mm)
- Weight:
  - HTS3510: 0.68 kg
  - HTS3520:
    - Centre: 0.77 kg
    - Front/Rear: 0.56 kg/each
- Cable length:
  - Centre: 3 m
  - Front: 4 m
  - Rear: 10 m

### Laser specification

- Type: Semiconductor laser GaAlAs (CD)
- Wave length: 645 - 665 nm (DVD), 770 - 800 nm (CD)
- Output power: 6 mW (DVD), 7 mW (VCD/CD)
- Beam divergence: 60 degrees.

## 9 Troubleshooting



### Warning

- Risk of electric shock. Never remove the casing of the product.

To keep the warranty valid, never try to repair the product yourself.

If you have problems using this product, check the following points before you request service. If you still have a problem, register your product and get support at [www.philips.com/welcome](http://www.philips.com/welcome).

If you contact Philips, you will be asked for the model and serial number of your product. The model number and serial number are on the back or bottom of your product. Write the numbers here:

Model No. \_\_\_\_\_

Serial No. \_\_\_\_\_

### Main unit

#### The buttons on this home theatre do not work.

- Disconnect the home theatre from the socket for a few minutes, then reconnect.

### Picture

#### No picture.

- Ensure that the TV is switched to the correct source for this home theatre.
- If this happens when you change the TV system, switch to its default mode: 1) Press **▲** 2) Press **◀**. 3) Press **SUBTITLE**.

#### No picture on HDMI connection.

- Check whether the HDMI cable is faulty. Replace with a new HDMI cable.
- If this happens when you change the HDMI video resolution, switch to its default mode: 1) Press **▲** 2) Press **◀**. 3) Press **ZOOM**.

## Sound

### No sound.

- Ensure that the audio cables are connected and select the correct input source (for example, **AUDIO SOURCE**) for the device you want to play.

### No sound on HDMI connection.

- You might not hear any sound if the connected device is not HDCP (High-bandwidth Digital Content Protection) compliant or only DVI compatible. Use an analogue or digital audio connection.
- Ensure that the **[HDMI Audio]** is enabled.

### No sound from TV programme.

- Connect an audio cable from the audio input on the home theatre to the audio output on the TV, then press **AUDIO SOURCE** repeatedly to select the correct audio source.

### Distorted sound or echo.

- Ensure that the TV volume is muted or set to minimum if you are playing audio through the home theatre.

### Audio and video are not synchronised.

- 1) Press and hold **AUDIO SYNC**. 2) Press **+/-** within five seconds.

## Play

### Disc cannot be played.

- Clean the disc.
- Ensure that the home theatre supports the disc (see 'Product specifications' on page 15).
- Ensure that the home theatre supports the region code of the DVD.
- For DVD±RW or DVD±R, ensure that the disc is finalised.

### The contents of a USB storage device cannot be read.

- Ensure that the format of the USB storage device is compatible with the home theatre.
- Ensure that the USB storage device is formatted with a file system that is supported by the home theatre (note that NTFS is not supported).

### 'No entry' or 'x' sign appears on the TV.

- The operation is not possible.

## 10 Index

### A

<b>amplifier</b>	15
<b>audio</b>	
connection	8
language	14, 10
settings	13
synchronise with video	11

### C

<b>care</b>	3
<b>change settings</b>	12
<b>connect</b>	
audio from TV	8, 11
guide	6
other devices	8
TV	7
<b>connectors</b>	6
<b>contact us</b>	16

### D

<b>disc</b>	
play	9
supported discs	15
<b>disposal of your product</b>	4

### F

<b>file formats</b>	15
---------------------	----

### L

<b>language</b>	
audio	14
disc menu	14
on-screen display	13
subtitle	14

### M

<b>MP3</b>	
create MP3 files	12

### O

<b>overview</b>	
connectors	6
main unit	4
remote control	5

---

<b>P</b>	
password	14
picture	
options	10
slide show	11, 10
thumbnail overview	10
troubleshooting	16
play	
disc	9
options	9
radio	11
troubleshooting	17
USB storage device	10
product care	3
product specifications	15

---

<b>R</b>	
radio	
play	11
programme	11
tune	11
recycle	4
region code	15
remote control	5
repeat	9
rotate pictures	10

---

<b>S</b>	
safety	3
settings	
audio	13
general	13
parental control	14
preferences	14
restore factory settings	14
video	13
software	
update	14
version	14
sound	
mode	8
surround	9
troubleshooting	17
subtitle	
language	10

---



---

<b>T</b>	
time search video	11
troubleshooting	16
<b>TV</b>	
audio from TV	8, 11
connect	7

---

<b>U</b>	
<b>USB</b>	
play	10
software update	14

---

<b>V</b>	
video	
options	10
settings	13
synchronise with audio	11

---