

PHILIPS

QC5570

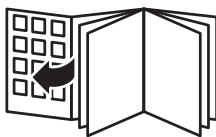

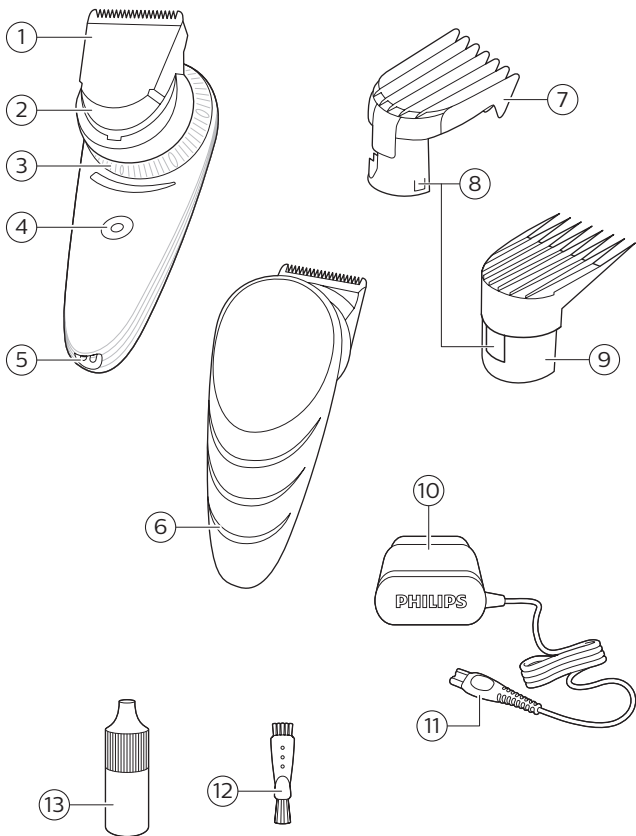



English 6
简体中文 **20**

Introduction

Congratulations on your purchase and welcome to Philips! To fully benefit from the support that Philips offers, register your product at www.philips.com/welcome.

Your new Philips hair clipper with new ergonomic design and 180° adjustable cutting element allows you to clip your own hair easily. You can move the clipper over all areas of your head as easily as running your fingers through your hair. To enjoy using the hair clipper, we advise you to read the following information.

General description (Fig. 1)

- 1 Cutting element
- 2 Swivel head
- 3 Length setting adjustment ring
- 4 On/off button
- 5 Socket for small plug
- 6 Battery charge indicator
- 7 Precision comb attachment
- 8 Length setting indicator
- 9 Regular comb attachment
- 10 Supply unit
- 11 Small plug
- 12 Cleaning brush
- 13 Oil

Important safety information

Read this important information carefully before you use the appliance and its accessories and save it for future reference. The accessories supplied may vary for different products.

Danger



- Keep the supply unit dry.

Warning

- To charge the battery, only use the detachable supply unit (HQ8505) provided with the appliance.
- The supply unit contains a transformer. Do not cut off the supply unit to replace it with another plug, as this causes a hazardous situation.
- This appliance can be used by children aged from 8 years and above and persons with reduced physical, sensory or mental capabilities or lack of experience and knowledge if they have been given supervision or instruction concerning use of the appliance in a safe way and understand the hazards involved. Children shall not play with the appliance. Cleaning and user maintenance shall not be made by children without supervision.
- Always unplug the appliance before you clean it under the tap.
- Always check the appliance before you use it. Do not use the appliance if it is damaged, as this may cause injury. Always replace a damaged part with one of the original type.
- This appliance contains batteries that are non-replaceable.
- Do not open the appliance to replace the rechargeable battery.

Caution



- Never immerse the charging stand in water and do not rinse it under the tap.
- Never immerse the appliance in water. Do not use the appliance in the bath or shower.
- Never use water hotter than 60°C to rinse the appliance.
- Only use this appliance for its intended purpose as shown in the user manual.
- For hygienic reasons, the appliance should only be used by one person.
- Do not use the supply unit in or near wall sockets that contain an electric air freshener to prevent irreparable damage to the supply unit.
- Never use compressed air, scouring pads, abrasive cleaning agents or aggressive liquids such as petrol or acetone to clean the appliance.

Electromagnetic fields (EMF)

This Philips appliance complies with all applicable standards and regulations regarding exposure to electromagnetic fields.

General



- This appliance can be safely cleaned under the tap.
- The supply unit is suitable for mains voltages ranging from 100 to 240 volts.
- The supply unit transforms 100-240 volts to a safe low voltage of less than 24 volts.

Charging

Charge the appliance before you use it for the first time and when the battery status indicator indicates that the battery is almost empty (see 'Battery charge indicator').

Note: Charge the appliance for at least 1 hour before you use it for the first time or after a long period of non-use.

Charging takes approx. 1 hour. A fully charged appliance has a operating time of up to 60 minutes.

Note: This appliance can be used cordless or directly from the wall socket.

Battery charge indicator

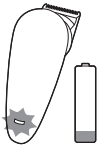

- When the battery is almost empty, the battery charge indicator flashes orange.
- When the appliance is charging, the battery charge indicator on the appliance flashes white.
- When the battery is fully charged, the battery charge indicator lights up white continuously.

Note: When the battery is full, the battery charge indicator switches off automatically after approx. 30 minutes.

Charging with the supply unit

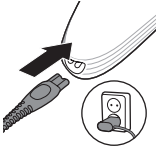

- 1 Put the small plug in the appliance and put the supply unit in the wall socket.

The battery charge indicator indicates that the appliance is charging (see 'Battery charge indicator').

- 2 After charging, remove the supply unit from the wall socket and pull the small plug out of the appliance.

Note: When the battery is full, the battery charge indicator switches off automatically after approx. 30 minutes.

Optimizing the lifetime of the rechargeable battery

Discharge the rechargeable battery completely twice

a year by letting the motor run until it stops. Then

fully recharge the battery.

Before first use

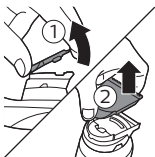

- 1 Pull the front of the cutting element upwards and remove the cutting element from the appliance.

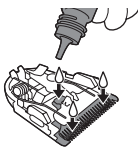

- 2 Turn the cutting element and lubricate the three points indicated with oil from the oil bottle supplied.

Using the appliance

This appliance can be used cordless or directly from the wall socket.

Preparing for use

Make sure your hair is clean and dry.



- 1 Comb your hair with a styling comb in the direction of hair growth.

Hairclipping tips

- We advise you to start clipping at the highest setting of the regular comb attachment and to reduce the setting gradually.
- To clip most effectively, move the appliance against the hair growth direction.

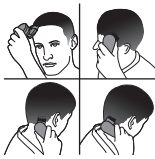

- Since all hair does not grow in the same direction, you need to move the appliance in different directions (upwards, downwards and across).
- Make sure that the flat part of the comb attachment is always fully in contact with the scalp to obtain an even result.
- Write down the settings you use to create a certain hairstyle as a reminder for future clipping sessions.

Using the swivel head

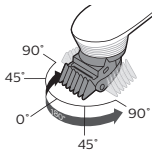

From its starting position of 0° (pointing forwards), you can turn the swivel head 45° or 90° to the left or right. This enables you to adjust the position of the cutting element to the part of your head that you are clipping. This makes it much easier to clip your own hair.



- 1 To set the cutting element to the desired position, turn the swivel head ('click').

Note: Always adjust the position of the cutting element by turning the swivel head. Do not turn the cutting element or the comb attachment.

Note: Do not turn the swivel head more than 90° to the left or right.



The swivel head allows you to hold and use the appliance like a styling comb.

Hair clipping with comb



- 1 Insert the edge of the comb attachment into the swivel head.

Make sure the comb attachment locks into position properly.

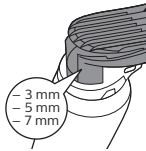

Note: The length settings are indicated on the comb attachment.



- 2 Turn the length setting adjustment ring to set the comb attachment to the desired setting.

The arrowhead on the appliance indicates which setting you have selected.



Tip: Use different settings to create a natural and smooth transition between the various hair lengths from your neckline to the top of your head.

Do not turn the length setting adjustment ring beyond the highest setting.

- 3 Turn the swivel head to the position that is most comfortable for your arm when you clip the different parts of your head (see 'Using the swivel head').
- 4 Press the on/off button to switch on the appliance.
QC5570: Press the button briefly.
QC5580: Press the button for 2 seconds.
- 5 Move the clipper through the hair slowly.

- 6** Regularly remove cut hair from the comb attachment.

If a lot of hair has accumulated in the comb attachment, remove the comb attachment from the appliance and blow and/or shake the hair out of it. When you remove the comb attachment, the selected setting does not change.

Contouring without comb

You can use the appliance without comb attachment to clip your hair very close to the skin (0,5mm) or to contour the neckline and the area around the ears.

Be careful when you clip without comb attachment because the cutting element removes every hair it touches.

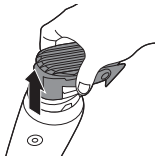

- 1** Pull the comb attachment off the swivel head.

Never pull at the flexible top of the comb attachment. Always pull at the bottom part.

- 2** Comb the hair ends over the ears before you start to contour the hairline.
- 3** Press the on/off button to switch on the appliance.
- 4** When you shape the contours around the ears, tilt the appliance in such a way that only one edge of the cutting element touches the hair ends.



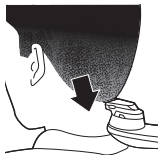

- 5 To contour the neckline and the sideburns, turn the appliance and make downward strokes.

Note: Move the appliance slowly and smoothly. Just follow the natural hairline.

- 6 Adjust the position of the swivel head to make contouring easier (see 'Using the swivel head').

Cleaning and maintenance

Regular cleaning guarantees better grooming results.

Never clean, remove or replace a shaving or cutting unit while the appliance is switched on.

Always check if the water is too hot, to prevent burning your hands.

Never dry cutting units or shaving foils with a towel or tissue, as this may cause damage.

Never use compressed air, scouring pads, abrasive cleaning agents or aggressive liquids such as petrol or acetone to clean the appliance.

Clean the appliance every time you have used it by rinsing it under the tap or with the cleaning brush supplied.

Always unplug the appliance before you clean it under the tap.

Be careful that the cutting element does not fall on the floor.

- 1 Switch off the appliance and disconnect it from the mains.
- 2 Remove the comb attachment.
- 3 Rinse the comb attachment under the tap or clean it with the cleaning brush supplied.

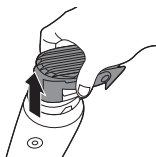



- 4** Place your thumb in the center of the round side of the cutting element and your index finger on the teeth of the cutting element. Use your index finger to lift the cutting element from the swivel head.

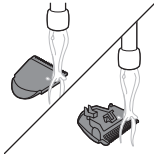

- 5** Rinse the cutting element under the tap or clean it with the cleaning brush supplied.

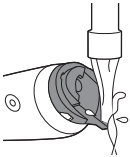

- 6** Rinse the inside of the appliance under the tap or clean it with the cleaning brush supplied.

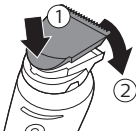

- 7** Insert the lug of the cutting element into the slot and push the cutting element back onto the swivel head.

Lubricate the cutting element

Lubricate the cutting element every 3 months with oil from the bottle supplied with the appliance.



- 1** Pull the front of the cutting element upwards and remove the cutting element from the appliance.

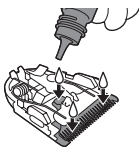

- 2 Turn the cutting element and lubricate the three points indicated.

Storage

- 1 Switch off the appliance and disconnect it from the mains.
- 2 Store the appliance and its accessories in the storage pouch supplied.

Ordering accessories

To buy accessories or spare parts, visit **www.philips.com/parts-and-accessories** or go to your Philips dealer. You can also contact the Philips Consumer Care Center in your country (see the international warranty leaflet for contact details).

Recycling

- Do not throw away the product with the normal household waste at the end of its life, but hand it in at an official collection point for recycling. By doing this, you help to preserve the environment.
- This product contains a built-in rechargeable battery which shall not be disposed of with normal household waste. Please take your product to an official collection point or a Philips service center to have a professional remove the rechargeable battery.

- Follow your country's rules for the separate collection of electrical and electronic products and rechargeable batteries. Correct disposal helps prevent negative consequences for the environment and human health.

Removing the rechargeable battery

Only remove the rechargeable battery when you discard the product. Before you remove the battery, make sure that the product is disconnected from the wall socket and that the battery is completely empty.

Take any necessary safety precautions when you handle tools to open the product and when you dispose of the rechargeable battery.

- 1 Disconnect the appliance from the mains and let the appliance run until the motor stops.
- 2 Remove the upper housing part of the appliance.
- 3 Open the inner body with a screwdriver.
- 4 Use a screwdriver to remove the rechargeable battery from the appliance.
- 5 Cut the wires with a pair of household scissors.

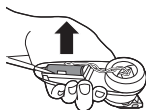
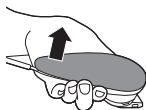

Troubleshooting

This chapter summarizes the most common problems you could encounter with the appliance. If you are unable to solve the problem with the

information below, visit www.philips.com/support for a list of frequently asked questions or contact the Consumer Care Center in your country.

Problem	Possible cause	Solution
The appliance produces an uneven cutting result.	The comb does not touch the skin when you move the appliance through the hair.	Make sure the comb is always fully in contact with the skin when you move the appliance through the hair.
	You only move the appliance in one direction.	Because not all hairs grow in the same direction, move the appliance in different directions (upwards, downwards and across).
	The setting of the comb has changed during trimming.	Check the setting of the comb. If you push the appliance too hard onto the scalp, you may accidentally change the setting of the comb.
	The comb is not assembled correctly.	Detach the comb and reattach it.
	The cutting performance decreases when the cutting unit and the comb are dirty.	Clean the cutting unit and the comb.
The appliance does not work when I switch it on.	The appliance is not connected to the the wall socket.	Insert the small plug into the appliance and put the supply unit in the wall socket.
I do not know how to attach the comb attachments to the appliance.		To attach the comb attachments, simply slide them into the slot in the appliance.

Problem	Possible cause	Solution
I do not know how to change the hair length settings of the comb attachments.		You can change the hair length settings of the comb attachments with the length setting adjustment ring on the appliance. Turn the ring to set the comb attachment to the desired setting. See chapter 'Using the appliance', section 'Hair clipping with comb'
One of the comb attachments is damaged or worn.		Do not use the comb attachment anymore. Replace it with an attachment or comb of the original type. You can obtain a replacement comb attachment from your local Philips dealer or you can visit www.philips.com/shop . For more information you can contact the Consumer Care

Warranty and support

If you need information or support, please visit www.philips.com/support or read the international warranty leaflet.

Warranty restrictions

Cutting units are not covered by the terms of the international warranty because they are subject to wear.

简介

感谢您的惠顾，欢迎光临飞利浦！为了让您能充分享受飞利浦提供的支持，请在 www.philips.com/welcome 上注册您的产品。

您新购买的飞利浦理发器采用全新人体工程学设计和 180° 可调节修剪部件，使您可以轻松为自己修剪头发。您可以将理发器在自己的整个头部移动，就好像手指划过头发一样轻松。要充分享受理发器的便利，建议您阅读以下信息。

基本说明 (图 1)

- 1 修剪部件
- 2 旋转头
- 3 长度设置调整环
- 4 开/关按钮
- 5 小插头插口
- 6 电池充电指示灯
- 7 精密梳齿附件
- 8 长度调校指示器
- 9 常规梳齿附件
- 10 电源部件
- 11 小插头
- 12 清洁刷
- 13 油

重要安全信息

使用本产品及其附件之前，请仔细阅读本重要信息，并妥善保管以供日后参考。随附的附件可能因产品而异。

危险



- 保持电源部件干燥。
- 警告符号注释：禁止在打开的水龙头下进行清洗。

警告

- 要给电池充电，请仅使用产品随附的可拆卸电源部件 (HQ8505)。
- 电源部件中包含一个变压器。请勿自行更换电源部件的插头，否则将导致严重后果。
- 本产品也可以由 8 岁或以上年龄的儿童以及肢体不健全、感觉或精神上有障碍或缺乏相关经验和知识的人士使用，但前提是有人对他们使用本产品进行监督或指导，以确保他们安全使用，并且让他们明白相关的危害。切勿让儿童玩弄本产品。不要让儿童在无人监督的情况下对本产品进行清洁和保养。
- 手持部分与电源软线分开后，才能在水中清洗手持部分。

22 简体中文

- 使用前，请务必检查产品。请勿使用损坏的产品，否则可能对人体造成伤害。请务必用原装型号更换损坏的部件。
- 本产品包含的电池不可更换。
- 切勿拆开本产品更换充电电池。

警告



- 切勿将充电座浸入水中，也不要在水龙头下冲洗。
- 切勿将产品浸入水中。请勿在洗澡或淋浴时使用本产品。
- 切勿使用温度高于 60° C 的热水冲洗本产品。
- 只能将本产品用于用户手册中所示的原定用途。
- 出于卫生的目的，本产品只能供一个人使用。
- 请勿在包含电动空气清新器的墙壁插座上或其周围使用电源部件，以免电源部件受到不可修复的损坏。
- 切勿使用压缩气体、钢丝绒、研磨性清洁剂或腐蚀性液体（例如汽油或丙酮）来清洁产品。

电磁场 (EMF)

本 Philips 产品符合所有有关暴露于电磁场的适用标准和法规。

概述



- 该产品可放心在水龙头下清洗。
- 符号注释：适合用在打开的水龙头下进行清洗。
- 电源部件适合在 100 - 240 伏的电源电压下工作。
- 该电源部件可将 100-240 伏的电压转换为 24 伏以下的安全低电压。

充电

第一次使用本产品之前，以及当电池状态指示灯指示电池电量快要耗尽 (请参见 '电池充电指示灯') 时，请为本产品充电。

注意： 首次使用前或长时间不用之后，请为产品至少充电 1 小时。

充电约需 1 小时。充满电的产品最长可使用 60 分钟。

注意： 本产品可以不接电源或直接连在插座上使用。

电池充电指示灯

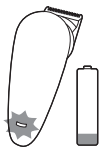

- 当电池的电量几乎耗尽时，电池充电指示灯会呈橙色闪烁。
- 产品充电时，其电池充电指示灯呈白色闪烁。
- 电池充满电后，电池充电指示灯将呈白色持续亮起。

注意： 电池充满电后，电池充电指示灯将在大约 30 分钟后自动关闭。

24 简体中文

使用电源部件充电

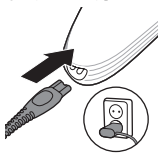

- 1 将小插头插入本产品，然后将电源部件插入电源插座。

电池充电指示灯指示产品正在充电 (请参见 '电池充电指示灯')。

- 2 充电之后，从电源插座上拔下电源部件，并从本产品上拔下小插头。

注意： 电池充满电后，电池充电指示灯将在大约 30 分钟后自动关闭。

优化充电电池寿命

每年将充电电池彻底放电两次，方法是让马达一直转动，直到不再转为止。然后将电池再次完全充电。

首次使用之前

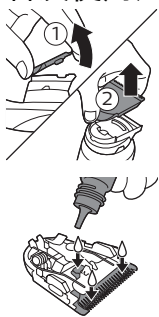

- 1 将修剪部件前端向上拉，然后从产品上取下修剪部件。

- 2 转动修剪部件，用随附油瓶中的油润滑所示的三个位置。

使用本产品

本产品可以不接电源或直接连在插座上使用。

使用准备

确保头发清洁干燥。

- 1 使用定型梳沿头发生长的方向梳理头发。



头发修剪提示

- 建议您从常规梳齿附件的最高设置开始修剪，然后逐渐缩短设置。
- 要获得最大修剪效率，请沿头发生长的反方向移动本产品。
- 因为头发不会全部以相同的方向生长，您需要以不同的方向移动产品（向上、向下或交叉）。
- 确保梳齿附件的扁平部分完全接触到头皮，以获得均匀的修剪效果。
- 记下您使用的设置，用作以后剪发过程中打造某种发型的参考。

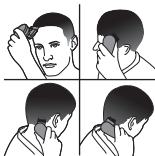

使用旋转头

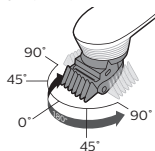

您可以将旋转头从开始位置 0° （指向前方）向左或向右旋转 45° 或 90° 。您可以通过这种方法调整修剪部件，以贴合待

26 简体中文

修剪头发部位的头部轮廓。这使您可以更轻松地为自己理发。



- 1 要将修剪部件设置到所需位置，请转动旋转头（可听到“咔哒”一声）。

注意：始终通过转动旋转头调整修剪部件的位置。请勿转动修剪部件或梳齿附件。

注意：请勿向左或向右转动旋转头超过 90° 。



您可以像握持定型梳一样握住旋转头来使用本产品。

使用修剪梳修剪头发



- 1 将梳齿附件的边缘插入旋转头。
确保梳齿附件正确锁定到位。

注意：梳齿附件上指示长度设置。

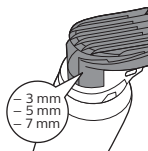



- 2 旋转长度设置调整环，将梳齿附件设为所需设置。

产品上的箭头表示您选择的设置。

提示：使用不同设置在从颈部到头顶的各种头发长度之间实现自然顺利的过渡。

切勿将长度设置调整环转到最高设置之外。

- 3 在修剪不同位置的头发 (请参见 '使用旋转头') 时，可以将旋转头转动到您的手臂感觉最舒服的位置。
- 4 按开/关按钮启动产品。
QC5570：短暂地按下按钮。
QC5580：按住按钮 2 秒钟。
- 5 将理发器在头发上缓慢移动。
- 6 定期清除梳齿附件中剪下的头发。

如果梳齿附件中积聚了许多头发，请先取下梳齿附件，吹去和/或抖掉梳齿附件上的头发。取出梳齿附件时，所选的设置不会改变。

不用梳齿的情况下修剪轮廓

即使没有梳齿附件，您也可以使用理发器以非常贴近头皮的距离（0.5 毫米）或紧

密贴合颈部周围和双耳附近的皮肤修剪头发。

由于修剪部件会去除接触到的每一根头发，因此在没有梳齿附件修剪头发时要小心。

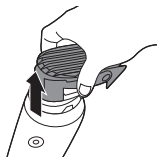

1 将梳齿附件从旋转头拉出。
切勿拔扯梳齿附件容易变形的顶部。请务必拉拔底部。

2 在开始紧贴双耳附近的发线修剪头发之前，请梳理耳朵上方的发梢。

3 按开/关按钮启动产品。

4 修整耳朵周围的轮廓时，倾斜产品，使修剪部件只有一边接触发梢。



5 要紧贴颈部周围和鬓角轮廓，请转动产品并向下修剪。

注意：缓慢、流畅地移动产品。只需顺着自然生长的发际线。

6 调整旋转头的位置，使修剪轮廓更容易（请参见‘使用旋转头’）。

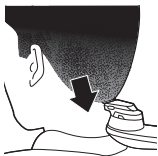

清洁和保养

为保证更好的修剪效果，请定期清洗剃毛刀。

切勿在产品开启时清洗、拆卸或更换剃毛或修剪部件。

切记先检查水温是否太高，以防烫手。

切勿使用毛巾或纸巾擦干修剪部件或剃毛刀网，因为有可能造成损坏。

切勿使用压缩气体、钢丝绒、研磨性清洁剂或腐蚀性液体（例如汽油或丙酮）清洁本产品。

每次用完产品后，请在水龙头下冲洗产品或用随附的清洁刷进行清洁。

在自来水龙头下清洗剃须刀之前，务必拔掉其电源插头。

小心不要让修剪部件掉落在地板上。

- 1 关闭产品并断开电源。
- 2 取下发梳。
- 3 在水龙头下冲洗梳齿附件或用随附的清洁刷进行清洁。
- 4 将拇指放在修剪部件的圆边中心，食指放在修剪部件的齿上。使用食指从旋转头提起修剪部件。

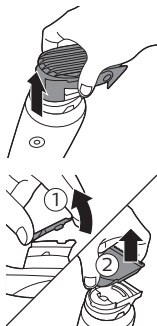

30 简体中文

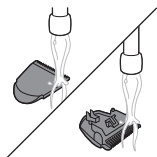

5 在水龙头下冲洗修剪部件或用随附的清洁刷进行清洁。

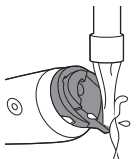

6 在水龙头下冲洗产品的内部或用随附的清洁刷进行清洁。

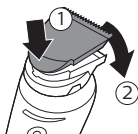

7 将修剪部件的凸缘插入槽内，然后将修剪部件推回旋转头。

润滑修剪部件

每 3 个月用产品随附的油瓶中的油润滑一次修剪部件。



1 将修剪部件前端向上拉，然后从产品上取下修剪部件。

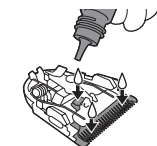

2 转动修剪部件并润滑所示的三个位置。

存放

- 1 关闭产品并断开电源。
- 2 将产品及其附件存放在随附的存储袋中。

订购配件

如需购买附件或备件，请访问 www.philips.com/parts-and-accessories 或联系您的飞利浦经销商。您还可以联系所在国家/地区的飞利浦客户服务中心（请参阅国际保修卡了解详细联系信息）。

回收

- 弃置本产品时，请不要将其与一般生活垃圾放在一起，应将其交给政府指定的回收中心。这样做将有利于环保。
- 此产品包含内置充电电池：请勿将充电电池与一般生活垃圾一起弃置。请您将产品送到官方收集中心或飞利浦服务中心，请专业人士移除充电电池。
- 遵循您的国家/地区有关分类回收电子电气产品和充电电池的规定。正确弃置产品有助于避免对环境和人类健康造成不良后果。

卸下充电电池

必须在丢弃本产品前拆下充电电池。卸下电池之前，请确保本产品与电源断开连接并且电池电量已耗尽。

当您使用工具打开本产品时以及在您弃置充电电池时，请采取必要的安全保护措施。

- 1 断开产品电源并让产品继续运行，直到马达停止。
- 2 去除产品的上顶盖部分。
- 3 使用螺丝刀打开产品内部主体。

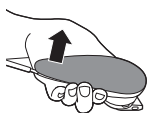

- 4 使用螺丝刀从产品取下充电电池。
- 5 使用家用剪刀剪断电线。

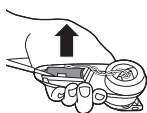

部件名称	产品中有害物质的名称及含量					
	有害物质					
	铅 (Pb)	汞 (Hg)	镉 (Cd)	六价铬 (Cr (VI))	多溴联苯 (PBB)	多溴二苯醚 (PBDE)
PCB's 集成电路板	X	○	○	○	○	○
Electrical contact pins 电接触片	X	○	○	○	○	○
Power plug 电源插头	X	○	○	○	○	○
Internal metal parts 内部金属件	X	○	○	○	○	○

本表格依据SJ/T 11364的规定编制。

○: 表示该有害物质在该部件所有均质材料中的含量均在GB/T 26572规定的限量要求以下。

X: 表示该有害物质至少在该部件的某一均质材料中的含量超出GB/T 26572规定的限量要求。

- 该表格中所显示的“有害物质”在产品正常使用情况下不会对人身和环境产生任何伤害。
- 该表格中所显示的“有害物质”及其存在的部件向消费者和回收处理从业者提供相关物质的存在信息，有助于产品废弃时的妥善处理。

故障处理方法

本章归纳了使用本产品时最常见的一些问题。如果您无法根据以下信息解决问题，请访问 www.philips.com/support 查阅常见问题列表，或联系您所在国家/地区的客户服务中心。

问题	可能的原因	解决方法
产品的修剪效果不均匀。	产品在头发上推动时没有触碰头皮。	修剪梳在头发上推动时，请确保修剪梳始终与皮肤完全接触。
	您只向一个方向移动产品。	由于并非所有头发都向一个方向生长，请朝不同方向移动产品（向上、向下以及交叉）。
	修剪过程中修剪梳的设置有所更改。	检查修剪梳的设置。如果您将产品过于用力地按在头皮上，您可能会意外更改修剪梳的设置。
	修剪梳组装不正确。	卸下修剪梳，重新安装。

34 简体中文

问题	可能的原因	解决方法
	如果修剪部件和修剪梳不干净，修剪性能会下降。	清洁修剪部件和修剪梳。
启动产品后，产品无法工作。	产品没有连接电源插座。	将充电插头插入产品，然后将电源部件插入电源插座。
我不知道如何将梳齿附件连接至产品。		要连接梳齿附件，只需将其滑入产品的插槽中即可。
我不知道如何更改梳齿附件的头发长度设置。		您可使用产品上的长度设置调整环更改梳齿附件的头发长度设置。旋转调整环，将梳齿附件设为所需设置。请参阅“使用产品”一章的“使用修剪梳修剪头发”部分
其中一个梳齿附件损坏或磨损。		切勿再使用梳齿附件。请使用原装型号的附件或梳齿更换。您可以从当地的飞利浦经销商获得替换梳齿附件，或访问 www.philips.com/shop 。有关更多信息，您可以联系飞利浦客户服务

保修和支持

如需信息或支持，请访问
www.philips.com/support 或阅读国际保修卡。

保修条款

修剪部件不在国际保修条款的涵盖范围之内，因为修剪部件属于易磨损物品。

PHILIPS	
产品	: 飞利浦自助理发器
型号	: QC5570
额定电压	: 220V~
额定频率	: 50Hz
额定输入功率	: 9 W
生产日期	: 请见产品本体
产地	: 匈牙利
飞利浦电子香港有限公司 香港新界沙田香港科学园科技道东五号	
经销单位: 飞利浦 (中国) 投资有限公司 上海市静安区灵石路718号A1幢 全国顾客服务热线: 4008 800 008	
本产品根据国标 GB4706.1-2005, GB4706.9-2008 制造	

PHILIPS

产品 : 飞利浦自助理发器
型号 : QC5570
额定电压 : 220V~
额定频率 : 50Hz
额定输入功率: 7.5 W
生产日期 : 请见产品本体
产地 : 匈牙利



飞利浦电子香港有限公司
香港新界沙田香港科学园科技道东五号

经销单位: 飞利浦(中国)投资有限公司
上海市静安区灵石路718号A1幢
全国顾客服务热线: 4008 800 008

本产品根据国标 GB4706.1-2005,
GB4706.9-2008 制造

保留备用

发行日期: 11/9/2018

— |

| —

— |

| —

— |

| —

— |

| —

© 2018 Koninklijke Philips N.V.

All rights reserved

保留所有权利

4222.002.8362.5 (11/9/2018)

> 75% 循环再造纸

保留备用



>75% recycled paper
>75% papier recyclé