

Always here to help you / 始终如一地为您提供帮助

Register your product and get support at / 请登录以下网址并得到相应的帮助
www.philips.com/welcome

AT798



User manual / 用户手册

PHILIPS



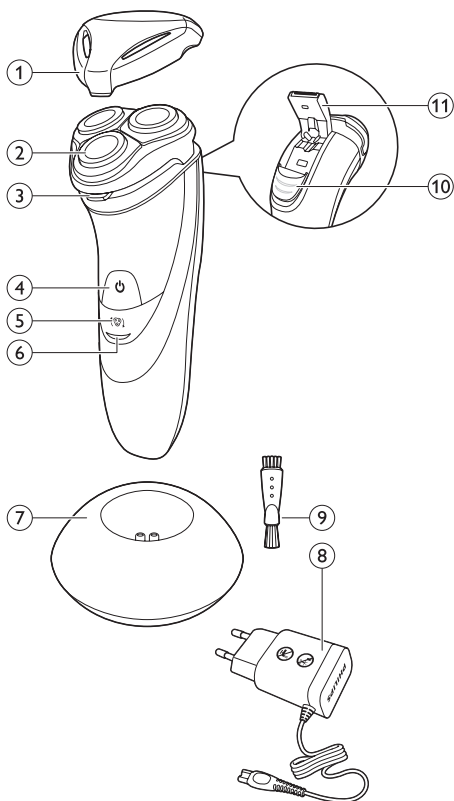

ENGLISH 6

简体中文 21

Introduction

Congratulations on your purchase and welcome to Philips! To fully benefit from the support that Philips offers, register your product at www.philips.com/welcome.

Please read this user manual, as it contains information about the wonderful features of this shaver as well as some tips to make shaving easier and more enjoyable.

General description (Fig. 1)

- 1 Protection cap
- 2 Shaving unit
- 3 Shaving unit release button
- 4 Shaver on/off button
- 5 Shaving head symbol
- 6 Charging light
- 7 Charging stand
- 8 Adapter
- 9 Cleaning brush
- 10 Trimmer release slide
- 11 Trimmer

Important

Read this user manual carefully before you use the shaver and the charging stand.

Danger

- Keep the adapter dry.

Warning

- The adapter contains a transformer. Do not cut off the adapter to replace it with another plug, as this causes a hazardous situation.



- This appliance can be used by children aged from 8 years and above and persons with reduced physical, sensory or mental capabilities, or lack of experience and knowledge if they have been given supervision or instruction concerning use of these appliance in a safe way and understand the hazards involved. Children shall not play with the appliance. Cleaning and user maintenance shall not be made by children unless they are older than 8 and supervised.
- Always unplug the shaver before you clean it under the tap.



Caution

- Never immerse the charging stand in water nor rinse it under the tap.
- Never use water hotter than 80°C to rinse the shaver.
- Do not use the shaver, adapter, charging stand or any other part if it is damaged, as this may cause injury. Always replace a damaged adapter, charging stand or part with one of the original type.
- Never use compressed air, scouring pads, abrasive cleaning agents or aggressive liquids such as petrol or acetone to clean the appliance.
- Water may leak from the socket at the bottom of the shaver when you rinse it. This is normal and not dangerous because all electronics are enclosed in a sealed power unit inside the shaver.



Compliance with standards

- This shaver is waterproof and complies with the internationally approved safety regulations. It is suitable for use in the bath or shower and for cleaning under the tap. For safety reasons, the shaver can therefore only be used cordlessly.
- The shaver complies with all applicable standards and regulations regarding exposure to electromagnetic fields.

General

- The adapter is equipped with an automatic voltage selector and is suitable for mains voltages ranging from 100 to 240 volts.
- The adapter transforms 100-240 volts to a safe low voltage of less than 24 volts.
- Maximum noise level: $L_c = 69\text{dB(A)}$

Charging

Note: *The shaver cannot be used directly from the mains.*

When you charge the shaver for the first time or after a long period of disuse, let it charge until the charging light lights up continuously.

See the table below for the charging time of your shaver: It takes approximately 8 hours to fully charge the shaver. A fully charged shaver provides up to 40 minutes of cordless shaving. The shaving time may be less than 40 minutes as a result of your shaving behaviour, your cleanings habits or your beard type.

Charge indications

Battery low

- When the battery is almost empty (when there are only 5 or fewer shaving minutes left), the charging light starts to flash orange. When you switch off the shaver, the charging light continues to flash orange for a few seconds.

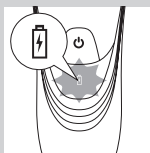

Charging

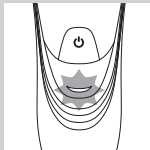

- When the shaver is charging, the charging light flashes green.

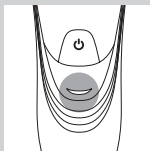

Battery fully charged

- When the battery is fully charged, the charging light lights up green continuously.

Note: After approx. 30 minutes, the charging light goes out to save energy.

Charging

- 1 Put the small plug in the shaver.
- 2 Put the adapter in the wall socket.
 - ▶ The charging light shows the charging status of the shaver (see section 'Charge indications' in this chapter).

Charging in the charging stand

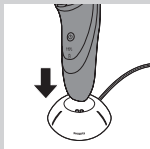

- 1 Put the small plug in the charging stand.
- 2 Put the adapter in the wall socket.
- 3 Place the shaver in the charging stand.
 - ▶ The charging light shows the charging status of the shaver (see section 'Charge indications' in this chapter).

Using the shaver

Note: This shaver can be used in the bath or shower. It can therefore not be used directly from the mains for safety reasons.

Shaving tips and tricks

- This shaver is suitable for both wet and dry use. Use the shaver with shaving gel or foam for extra skin comfort, or use the shaver dry for extra convenience.

Note: We advise you to use the shaver with shaving gel or foam when you use it for a wet shave. Do not use thick shaving cream or shaving oil with this shaver.

- For optimal shaving results, make circular movements during use.
- The shaver is waterproof and can be used in the bath or shower.
- Your skin may need 2 or 3 weeks to get accustomed to the Philips shaving system.

Wet shaving

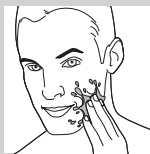

- 1** Apply some water to your skin.

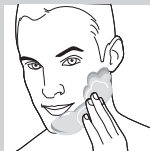

- 2** Apply shaving foam or shaving gel to your skin.
- 3** Rinse the shaving unit under the tap to ensure that the shaving unit glides smoothly over your skin.
- 4** Press the on/off button once to switch on the shaver.



- 5 Move the shaving heads in circular movements over your skin.

Note: Rinse the shaver under the tap regularly to ensure that it continues to glide smoothly over your skin.

- 6 After shaving, press the on/off button once to switch off the shaver and dry your face.

- 7 Clean the shaver (see chapter 'Cleaning and maintenance').

Note: Make sure you rinse all foam or shaving gel off the shaver.

Dry shaving

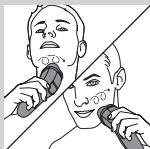

- 1 Press the on/off button once to switch on the shaver.

- 2 Move the shaving heads in circular movements over your skin.

- 3 After shaving, press the on/off button once to switch off the shaver.

- 4 Clean the shaver (see chapter 'Cleaning and maintenance').

Trimming

You can use the trimmer to groom your sideburns and moustache.

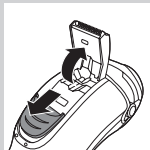

- 1 Push the trimmer slide downwards to open the trimmer.

- 2 Press the on/off button once to switch on the shaver.

► You can now start trimming.

- 3 After trimming, press the on/off button once to switch off the shaver.

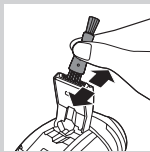

4 Clean the trimmer (see chapter 'Cleaning and maintenance').

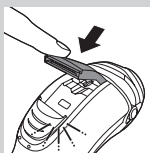

5 Close the trimmer ('click').

Cleaning and maintenance

Never use compressed air, scouring pads, abrasive cleaning agents or aggressive liquids such as petrol or acetone to clean the shaver and the charging stand.

Always unplug the shaver before you clean it under the tap.

- Clean the shaver after every shave for optimal shaving performance.
- Regular cleaning guarantees better shaving performance.
- For the best cleaning results, we advise you to use the Philips Cleaning spray (HQ110).
- Be careful with hot water. Always check if the water is not too hot, to prevent your hands from getting burnt.

Note: Water may leak from the socket at the bottom of the shaver when you rinse it. This is normal and not dangerous because all electronics are enclosed in a sealed power unit inside the shaver.

Cleaning the shaving unit under the tap



- 1 Switch off the shaver.
- 2 Press the release button to open the shaving unit.

- 3 Rinse the shaving unit and hair chamber under a hot tap for 30 seconds.

Be careful with hot water. Always check if the water is not too hot, to prevent your hands from getting burnt.

- Rinse the hair chamber and the inside of the shaving unit.

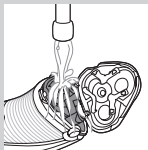

- Rinse the outside of the shaving unit.

- 4 Close the shaving unit and shake off excess water.

Be careful not to hit the shaving unit against anything while shaking off excess water.

Never dry the shaving unit and the hair chamber with a towel or tissue, as this may damage the shaving unit.



- 5 Open the shaving unit again and leave it open to let the shaver dry completely.

Cleaning the shaving unit with the cleaning brush



1 Switch off the shaver.

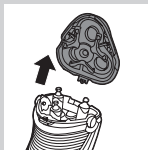

2 Press the release button to open the shaving unit.

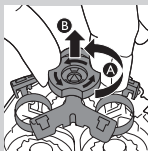

3 Pull the shaving unit off the shaver.

4 Turn the lock anticlockwise (A) and remove the retaining frame (B).

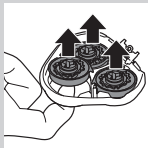

5 Remove and clean one shaving head at a time. Each shaving head consists of a cutter and a guard.

Note: Do not clean more than one cutter and guard at a time, since they are all matching sets. If you accidentally mix up the cutters and guards, it may take several weeks before optimal shaving performance is restored.

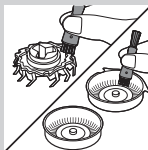

- Remove the cutter from the shaving guard and clean it with the brush.
- Clean the inside and outside of the shaving guard with the brush.

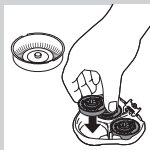

- 6** Put the shaving heads back into the shaving unit.

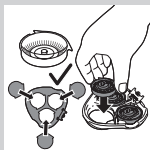

Make sure that the projections of the shaving heads fit exactly into the recesses.

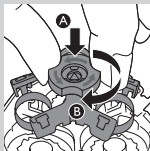

- 7** Put the retaining frame back into the shaving unit (A) and turn the lock clockwise (B).

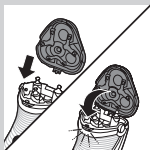

- 8** Insert the lug of the shaving unit into the slot in the top of the shaver. Then close the shaving unit.

Note: If the shaving unit does not close smoothly, check if you have inserted the shaving heads properly and if the retaining frame is locked.

Cleaning the trimmer with the cleaning brush

Clean the trimmer every time you have used it.

- 1** Switch off the shaver.
- 2** Push the trimmer slide downwards to open the trimmer.

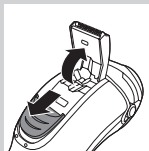

- 3** Clean the trimmer with the short-bristled side of the cleaning brush. Brush up and down along the trimmer teeth.

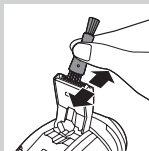

- 4** Close the trimmer ('click').



Tip: For optimal trimming performance, lubricate the trimmer teeth with a drop of sewing machine oil every six months.

Storage

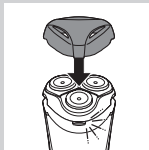

- Put the protection cap on the shaver to prevent damage.

Replacement

For maximum shaving performance, we advise you to replace the shaving heads every two years.

Replacement reminder

The shaving head symbol will light up to indicate that the shaving heads need to be replaced. Replace damaged shaving heads right away.

Only replace the shaving heads with original HQ8 Philips Shaving Heads.



- 1** The shaving head symbol lights up orange continuously.
- 2** Switch off the shaver. Disconnect the shaver from the mains or remove it from the charging stand.
- 3** Press the release button to open the shaving unit.
- 4** Pull the shaving unit off the shaver.



- 5** Turn the lock anticlockwise (A) and remove the retaining frame (B).
- 6** Remove the shaving heads and place new ones in the shaving unit.

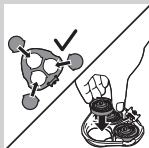
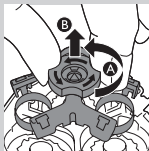

Make sure that the projections of the shaving heads fit exactly into the recesses.

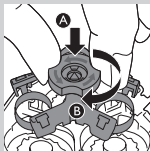

- 7** Put the retaining frame back into the shaving unit (A) and turn the lock clockwise (B).

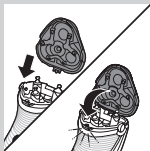

- 8** Insert the lug of the shaving unit into the slot in the top of the shaver. Then close the shaving unit.

Note: If the shaving unit does not close smoothly, check if you have inserted the shaving heads properly and if the retaining frame is locked.

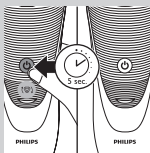

- 9** Press and hold the on/off button for 5 seconds to reset the replacement reminder on the shaver. The orange light will go out.

Ordering accessories

To buy accessories or spare parts, visit **www.shop.philips.com/service** or go to your Philips dealer. You can also contact the Philips Consumer Care Centre in your country (see the worldwide guarantee leaflet for contact details). To retain the top performance of your shaver, make sure you clean it regularly and replace its shaving heads at the recommended time.

Shaving heads

- We advise you to replace your shaving heads every two years. Always replace with HQ8 Philips Shaving Heads.



Cleaning

- Use Cleaning spray (HQ110) to clean the shaving heads thoroughly.

Environment

Do not throw away the appliance with the normal household waste at the end of its life, but hand it in at an official collection point for recycling. By doing this, you help to preserve the environment.

Guarantee and support

If you need information or support, please visit **www.philips.com/support** or read the separate worldwide guarantee leaflet.

Guarantee restrictions

The shaving heads (cutters and guards) are not covered by the terms of the international guarantee because they are subject to wear.

Troubleshooting

This chapter summarises the most common problems you could encounter with the appliance. If you are unable to solve the problem with the information below, visit **www.philips.com/support** for a list of frequently asked questions or contact the Consumer Care Centre in your country.

Problem	Possible cause	Solution
The shaver does not shave as well as it used to.	The shaving heads are damaged or worn.	Replace the shaving heads (see chapter 'Replacement').
	Foam or gel residues clog up the shaving heads.	Rinse the shaving unit under a hot tap (see chapter 'Cleaning and maintenance').
	Long hairs obstruct the shaving heads.	Clean the shaving heads one by one (see chapter 'Cleaning and maintenance').
	You have not inserted the shaving heads properly.	Make sure that the projections of the shaving heads fit exactly into the recesses (see chapter 'Cleaning and maintenance').
The shaver does not work when I press the on/off button.	The rechargeable battery is empty.	Recharge the battery (see chapter 'Charging').
	The temperature of the shaver is too high. In this case, the shaver does not work.	As soon as the temperature of the shaver has dropped sufficiently, you can switch on the shaver again.
The shaver does not work, although it is connected to the mains.	The shaver is not designed to be used directly from the mains.	Recharge the battery (see chapter 'Charging') and disconnect it from the mains.

简介

感谢您的惠顾，欢迎光临飞利浦！
为了您能充分享受飞利浦提供的支持，请在 www.philips.com/welcome 上注册您的产品。
请阅读本用户手册，手册包含有关此剃须刀各种功能的信息以及一些使用技巧，让您的剃须体验更轻松更舒适。

基本说明 (图 1)

- 1 保护盖
- 2 剃毛刀头部件
- 3 剃须刀头部件释放按钮
- 4 剃须刀开/关按钮
- 5 剃须刀头符号
- 6 充电指示灯
- 7 充电座
- 8 适配器
- 9 清洁刷
- 10 修发器释放滑块
- 11 修发器

注意事项

使用剃须刀和充电座之前，
请仔细阅读本用户手册。

危险

- 保持适配器干燥。
- 警告符号注释：禁止用在打开的水龙头下进行清洗。



警告

- 电源适配器内含有一个变压器。切勿自行更换插头，否则将导致严重后果。
- 本产品适合由 8 岁或以上年龄的儿童以及肢体不健全、感觉或精神上有障碍或缺乏相关经验和知识的人士使用，但前提是有人对他们使用本产品进行监督或指导，以确保他们安全使用，并且让他们明白相关的危害。不得让儿童玩耍本产品。不要让儿童进行清洁和保养，除非儿童已年满 8 周岁且在有人监督的情况下。
- 在自来水龙头下清洗剃须刀之前，务必拔掉其电源插头。

警告

- 切勿将充电座浸入水中，也不要再在自来水龙头下冲洗。
- 警告符号注释：禁止用在打开的水龙头下进行清洗。
- 切勿使用温度高于 80° C 的热水冲洗剃须刀。



- 如果剃须刀、适配器、充电座或任何其他部件损坏，请勿再使用，否则可能对人体造成伤害。务必用原始型号更换损坏的适配器、充电座或任何其他部件。
- 切勿使用压缩气体、钢丝绒、研磨性清洁剂或腐蚀性液体（例如汽油或丙酮）来清洁产品。
- 冲洗产品时，水可能从剃须刀底部的插口漏出。这是正常的，而且没有危险，因为所有的电子线路都密封在剃须刀内的一个密封壳内。

符合标准

- 此剃须刀可防水并符合国际认可的安全标准。它还可在沐浴或淋浴时使用，也可以在水龙头下清洁。出于安全考虑，剃须刀只能在不接电源的情况下使用。
- 符号注释：适合于在洗澡或淋浴时使用。
- 允许在盛水的浴缸、淋浴、洗脸盆或其他器皿附近使用本器具（剃须刀）。
- 该剃须刀符合所有有关暴露于电磁场的适用标准和法规。



概述

- 本适配器配有自动电压选择器，适合 100 至 240 伏范围内的电源电压。
- 电源适配器可将 100-240 伏的电压转换为 24 伏以下的安全低电压。
- 最大噪音强度：Lc = 69dB(A)

充电

注意：剃须刀不能连在电源上直接使用。

如果是第一次为剃须刀充电，或是长时间未使用后充电，应让其连续充电，直到充电指示灯持续亮起。

有关剃须刀的充电时间，请参阅下表。

该剃须刀充满电需要大约 8 小时。完全充电的剃须刀可提供多达 40 分钟无绳剃须。剃须时间可能会因剃须行为、清洁习惯或胡须类型的差异而少于 40 分钟。

充电指示

电池电量不足

- 当电池电量快要耗尽时（仅剩 5 分钟或更少的剃须时间），充电指示灯开始呈橙色闪烁。关闭剃须刀时，充电指示灯将呈橙色持续闪烁几秒钟。

充电

- 剃须刀在充电时，充电指示灯闪烁绿色。

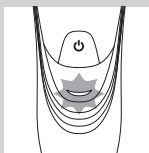
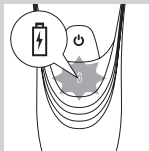

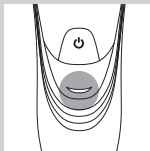

电池已完全充满

- 电池充满电时，充电指示灯将持续亮起绿灯。

注意：大约 30 分钟后，充电指示灯熄灭以节省能源。

充电

- 1 将小插头插入剃须刀。
- 2 将电源适配器插入电源插座。
- ▶ 充电指示灯显示剃须刀的状态（见本章中的“充电指示”一节）。

在充电座内充电

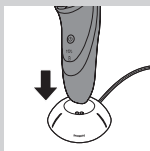

- 1 将小插头插入充电座。
- 2 将电源适配器插入电源插座。
- 3 将剃须刀插接在充电座中。
- ▶ 充电指示灯显示剃须刀的状态（见本章中的“充电指示”一节）。

使用剃须刀

注意：本款剃须刀可在沐浴或淋浴过程中使用。因此，出于安全原因，其不能直接连在电源上使用。

剃须提示和诀窍

- 这款剃须刀适合干湿两用。可使用剃须啫喱或泡沫湿剃，令皮肤倍感舒爽；或采用干式剃须，更为方便。

注意：建议在湿剃时使用剃须啫喱或泡沫。请勿使用浓稠的剃毛乳液或剃毛油。

- 为获得更佳的剃须效果，请在使用时作迂回运动。
- 该剃须刀采用防水设计，可在沐浴或淋浴时使用。
- 您的皮肤可能需要 2 到 3 周才能适应飞利浦剃须系统。

湿剃

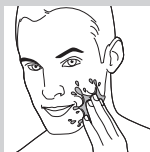

1 用水润湿一下皮肤。

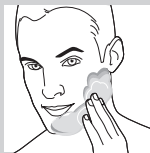

2 在皮肤上涂上剃须泡沫或剃须啫喱。

3 在水龙头上冲洗一下剃须刀头部件，确保剃须刀头部件可以在您的皮肤上顺畅滑动。

4 按一下开/关按钮以启动剃须刀。

5 将剃须刀头在您的皮肤上作迂回运动。



注意：在水龙头下定期冲洗剃须刀，确保其能够继续在您的皮肤上顺畅滑动。

6 剃须后，按一下开/关按钮关闭剃须刀电源并把脸擦干。

7 清洁剃须刀（见“清洁和保养”一章）。

注意：确保冲洗干净剃须刀上的泡沫或剃须啫喱。

干电式剃须刀

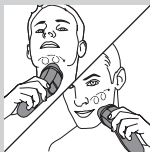

- 1** 按一下开/关按钮以启动剃须刀。
- 2** 将剃须刀头在您的皮肤上作迂回运动。
- 3** 剃须后，按一下开/关按钮关闭剃须刀电源。
- 4** 清洁剃须刀（见“清洁和保养”一章）。

修发

您可使用修剪器修剪鬓角和小胡子。

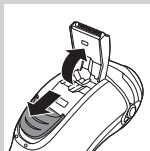

- 1** 向下推修剪器的滑动开关可打开修剪器。
- 2** 按一下开/关按钮以启动剃须刀。
▶ 现在可以开始修剪了。

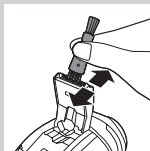

- 3** 修剪后，按一下开/关按钮关闭剃须刀电源。
- 4** 清洁修剪器（见“清洁和保养”一章）。

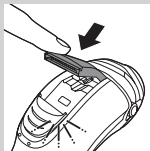

- 5** 关闭修剪器（可听到“咔哒”一声）。

清洁和保养

切勿使用压缩气体、钢丝绒、研磨性清洁剂或腐蚀性液体（例如汽油或丙酮）来清洁剃须刀和充电座。

在自来水龙头下清洗剃须刀之前，务必拔掉其电源插头。

- 每次剃须后清洁剃须刀，以获得更佳的剃须性能。
- 为保证更好的剃须效果，剃须刀必须定期清洗。
- 为了获得更佳的清洁效果，建议您使用飞利浦清洁喷雾剂 (HQ110)。
- 使用热水时一定要小心。切记先检查水温是否太高，以防烫手。

注意：冲洗产品时，水可能从剃须刀底部的插口漏出。这是正常的，而且没有危险，因为所有的电子线路都密封在剃须刀内的一个密封壳内。

在水龙头下冲洗剃须刀头部件



1 关闭剃须刀。

2 按下释放按钮，打开剃须刀头部件。

3 在热水龙头下将剃须刀头部件和胡茬储藏室冲洗 30 秒。

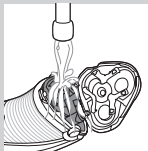

使用热水时一定要小心。切记先检查水温是否太高，以防烫手。

- 冲洗胡茬储藏室和剃须刀头部件内部。



- 冲洗剃须刀头部件外侧。

4 关闭剃须刀头部件并甩掉多余的水份。

甩掉多余的水份时，小心不要使剃须刀头部件敲到任何东西。

不要用毛巾或纸巾来擦干剃须刀头部件和胡茬储藏室，因为这样可能会损坏剃须刀头部件。

5 再次打开剃须刀头部件，使它保持打开状态，使其完全晾干。

用随附的刷子清洁剃须刀头部件



1 关闭剃须刀。

2 按下释放按钮，打开剃须刀头部件。

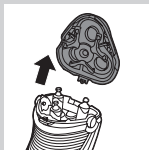

3 将剃须刀头部件拉出剃须刀。

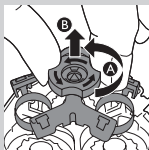

4 逆时针转动锁定装置 (A)，取下固定架 (B)。

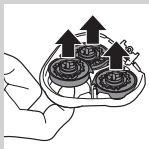

- 5** 一次取下并清洁一个剃须刀头。每个剃须刀头包含一组刀片和网罩。

注意：不要同时清洁多组刀片和网罩，因为它们都是相互匹配的。如果不小心将刀片和网罩弄混，则需要数周时间才能恢复产品的更佳剃须性能。

- 从网罩取下刀片并用清洁刷进行清洁。
- 用清洁刷里里外外清洁网罩。

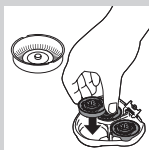
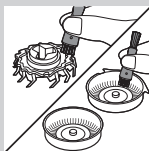

- 6** 将剃须刀头重新放入剃须刀头部件。

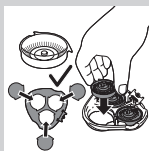

确保剃须刀头凸起部位正好插入凹陷部位。

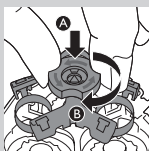

- 7** 将固定架放回剃须刀头部件 (A)，顺时针转动锁定装置 (B)。

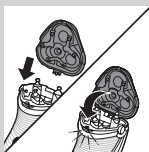

- 8** 将剃须刀头部件的凸缘插入剃须刀顶部的槽内。然后关闭剃须刀头部件。

注意：如果剃须刀头部件关闭不畅，请检查剃须刀头插入是否正确，固定架是否被锁住。

使用清洁刷清洁修发器

每次使用后都要清洁修剪器。

- 1** 关闭剃须刀。
- 2** 向下推修剪器的滑动开关可打开修剪器。
- 3** 使用清洁刷的短毛一侧清洁修剪器。
沿着修剪器齿上下刷净。
- 4** 关闭修剪器（可听到“咔哒”一声）。

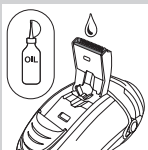
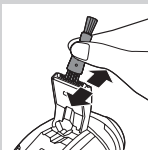
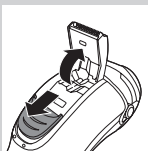

提示：为获得更佳修剪性能，请每隔六个月用一滴缝纫机油润滑修剪器齿。

存储

- 盖上剃须刀保护盖，以防受损。

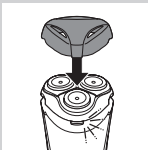

更换

为获得更佳剃须效果，建议您两年更换一次剃须刀头。

更换提醒

剃须刀头符号会亮起，指示需要更换剃须刀头。应立即更换损坏的剃须刀头。

只能用原装 HQ8 飞利浦剃须刀头进行更换。



1 剃须刀头符号会呈橙色持续亮起。

2 关闭剃须刀。断开剃须刀的电源或将其从充电座中取出。



3 按下释放按钮，打开剃须刀头部件。

4 将剃须刀头部件拉出剃须刀。

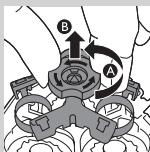

5 逆时针转动锁定装置 (A)，取下固定架 (B)。

6 取下剃须刀头，在剃须刀头部件上装上新刀头。

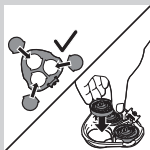

确保剃须刀头凸起部位正好插入凹陷部位。

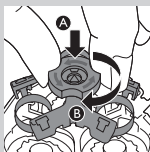

7 将固定架放回剃须刀头部件 (A)，顺时针转动锁定装置 (B)。

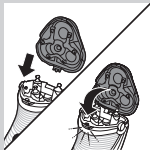

- 8** 将剃须刀头部件的凸缘插入剃须刀顶部的槽内。然后关闭剃须刀头部件。

注意：如果剃须刀头部件关闭不畅，请检查剃须刀头插入是否正确，固定架是否被锁住。

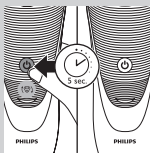

- 9** 按住开/关按钮 5 秒钟可重置剃须刀更换提醒。橙色指示灯会熄灭。

订购附件

要购买附件和备件，请访问 www.shop.philips.com/service 或 请联系飞利浦经销商。您也可以联系您所在国家/地区的飞利浦客户服务中心（联系详情，请参阅全球保修卡）。为了保持剃须刀的最佳性能，请确保定期清洁并在推荐的时间更换剃须刀头。

剃须刀头

- 建议您每两年更换一次剃须刀头。务必使用 HQ8 剃须刀头进行更换。

清洁

- 使用清洁喷雾剂 (HQ110) 彻底清洁剃须刀头。



环保

弃置产品时，请不要将其与一般生活垃圾堆放在一起；应将其交给官方指定的回收点。

这样做有利于环保。

在废弃器具前，必须将电池从器具中取出；

在取出电池时，器具必须要断电；电池应安全地处置。

保修和支持

如果您需要信息或支持，请访问 www.philips.com/support 或阅读单独的全球保修卡。

保修条款

由于剃须刀头（刀片和网罩）属于易磨损物品，因此不在国际保修条款的涵盖范围之列。

故障种类和处理方法

本章归纳了使用本产品时最常见的一些问题。如果您无法根据以下信息解决问题，请访问 www.philips.com/support 查阅常见问题列表，或联系您所在国家/地区的客户服务中心。

问题	可能的原因	解决方法
剃须刀的剃须效果没有以前好。	剃须刀头已损坏或磨损。	更换剃须刀头（见“更换”一章）。
	剃须泡沫或剃须啫喱堵塞了剃须刀头。	在热水龙头下冲洗剃须刀头部件（见“清洁和保养”一章）。
	过长的胡须堵塞了剃须刀头。	逐一清洁剃须刀头（参阅“清洁和保养”一章）。
	您没有正确插入剃须刀头。	确保剃须刀头凸起部位正好插入凹陷部位（见“清洁和保养”一章）。
按下开/关按钮时，剃须刀不工作。	充电电池的电量已耗尽。	给电池充电（见“充电”一章）。

问题	可能的原因	解决方法
	剃须刀的温度过高。此时，剃须刀无法工作。	一旦剃须刀降到足够低的温度，便可重新打开剃须刀。
尽管已接上电源，但剃须刀不工作。	该剃须刀不可直接插电使用。	为电池充电（参阅“充电”一章），然后断开电源。

PHILIPS

产品 : 飞利浦电动剃须刀
 型号 : AT798
 额定电压 : 220V~
 额定频率 : 50Hz
 额定输入功率: 2 W
 生产日期 : 请见产品本体
 产地 : 中国广东珠海



珠海经济特区飞利浦家庭电器有限公司
 中国珠海市三灶镇琴石工业区
 全国顾客服务热线: 4008 800 008

本产品根据国标 GB4706.1-2005, GB4706.9-2008制造

保留备用

发行日期：06/02/2018

产品中有害物质的名称及含量						
部件名称	有害物质					
	铅 (Pb)	汞 (Hg)	镉 (Cd)	六价铬 (Cr (VI))	多溴联苯 (PBB)	多溴二苯醚 (PBDE)
PCB's 集成电路板	X	O	O	O	O	O
Electrical contact pins 电接触片	X	O	O	O	O	O
Power plug 电源插头	X	O	O	O	O	O
本表格依据SJ/T 11364的规定编制。						
O: 表示该有害物质在该部件所有均质材料中的含量均在GB/T 26572规定的限量要求以下。						
X: 表示该有害物质至少在该部件的某一均质材料中的含量超出GB/T 26572规定的限量要求。						



www.philips.com



100% recycled paper
100% 循环再造纸

4222.002.5681.2