



Philips  
Soundbar speaker

5.1 CH wireless subwoofer  
Bluetooth® aptX, AAC and NFC  
HDMI 4K-2K  
Ambisound technology



HTL7140B

## Immersive surround sound for any TV

with wireless subwoofer

Designed to deliver immersive surround sound, this Philips soundbar speaker HTL7140B uses the latest patented Ambisound technology, 5.1 channels with 320W total output and precision angled drivers to create sound far larger than itself.

### Richer sound for watching TV and movies

- Ambisound technology for true surround sound experience
- 5.1 Multi-channel for true immersive surround sound
- Dedicated center channel for true voice clarity
- Precisely angled drivers positioning for wider sound effect
- Powerful 320W sound output
- Dolby Digital and DTS for great surround sound
- 8" woofer for thumping bass

### Connect and enjoy all your entertainment

- HDMI 4K2K pass-through for ultra HD content enjoyment
- Bluetooth® (aptX® and AAC) for wireless music streaming
- One-Touch with NFC-enabled smartphones for Bluetooth pairing

### Designed to enhance your living space

- Wireless subwoofer for clutter free placement
- Sleek and modern form factor matches any TV

# PHILIPS

Soundbar speaker  
5.1 CH wireless subwoofer Bluetooth® aptX ,AAC and NFC, HDMI 4K-2K, Ambisound technology

HTL7140B/12

# Highlights

## Ambisound

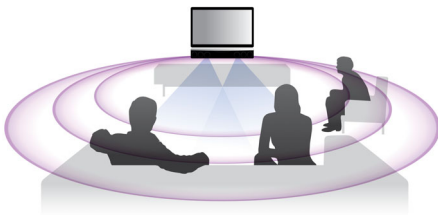

Ambisound technology produces truly embracing multi-channel surround sound from sleek soundbar. It delivers an immersive 5.1 sound experience without the constraints of sitting position, room shape or size, and without the clutter of multiple speakers and cables. Through the combined effect of psychoacoustic phenomena, array processing and precisely angled driver positioning, Ambisound delivers truly immersive and wider sound effect.

## 5.1 Multi-channel

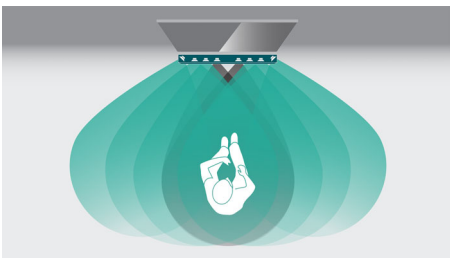

HTL7140B is a 5.1 multi-channel to deliver truly immersive sound effect. Added more, most of the soundbar nowadays is 2.1 channels, HTL7140B equipped 5.1 channels with built-in 6 amplifiers to deliver great sound quality. This 5.1 systems use the same speaker channels and configuration, having a front left and right, a center channel, two surround channels and a subwoofer. It support Dolby digital pro-logic 2.

## Dedicated center channel



Most of the soundbar in the market is with 2.1 channels. The center channel is down mix into 2.1 channel and the voice is not clear. HTL7140B with 2 dedicated drivers, have their own amplifier and carry a different processed sound signal. By carefully processing the sound, it is possible to create a wider soundstage than when the drivers carry the same sound. The soundstage becomes larger than the length of the soundbar. While consumer watch the foreign TV program or movie, they can follow it easily. Same as watching TV news.

## HDMI 4K2K

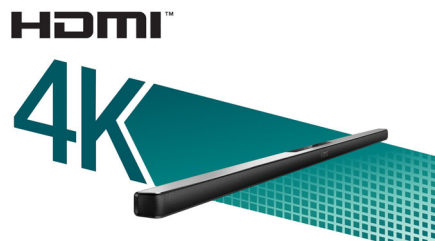

HDMI 4K2K incorporates the HDMI 1.4 standard. This adds support for ultra-high definition (UHD) video content. Presently this refers to 4K, which at its largest is 4096 pixels wide by 2160 pixels high or four times the size of a standard 1080p HD display. The term covers a slightly lower 4K resolution of 3840 pixels wide by 2160 pixels high. Both formats are supported through HDMI 1.4. 4K displays put high-end home theater systems in the same sphere used in many commercial movie theaters. To make the speakers future resistant, this standard has been integrated for the growth of 4K TV.

## Dolby Digital and DTS

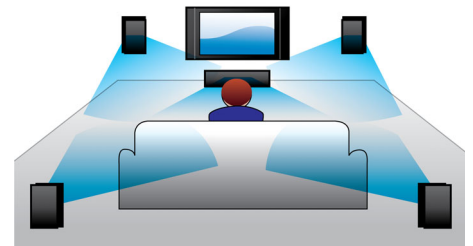

Go digital and get the most out of your music and movies. Even stereo music sounds great because Dolby Digital and DTS Digital Surround enhance digital music and videos, pumping it up so you get truly immersive surround sound out of your home cinema speaker.

## Precisely angled drivers



The tweeters are angled at 45 degrees and send the high frequencies sideward, enlarging the soundstage also for the high frequencies. With the combination of the front positioned drivers, the angled tweeters and the proprietary processing and acoustics is called Ambisound and deliver wider sound effect.

## NFC technology

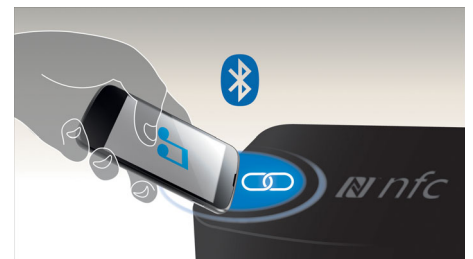

Pair Bluetooth devices easily with one-touch NFC (Near Field Communications) technology. Just tap the NFC enabled smartphone or tablet on the NFC area of a speaker to turn the speaker on, start Bluetooth pairing, and begin streaming music.



## Soundbar speaker

5.1 CH wireless subwoofer Bluetooth® aptX, AAC and NFC, HDMI 4K-2K, Ambisound technology

HTL7140B/12

# Specifications

### Sound

- Sound Enhancement: Treble and Bass Control, Audio sync, Auto Volume Leveller, Movie, Music, Voice, Smart Sound
- Sound System: Dolby pro-logic 2, DTS Digital Surround
- Subwoofer output power: 220W
- Speaker output power: 100W
- Total Power RMS @ 10% THD: 320 W

### Loudspeakers

- Subwoofer driver: 1 x 8" woofer
- Subwoofer type: Wireless subwoofer, Bass reflex system
- Drivers per Soundbar: 2 speakers for center channel, 2X 1" mylar tweeters, 4 speakers for front/surround

### Connectivity

- Rear Connections: Digital optical in, HDMI 1.4 output (ARC), HDMI IN 1, Audio in 3.5 mm jack, USB
- Wireless connections: Bluetooth APT-X and AAC
- Integrated Connections: Bluetooth APT-X, NFC

### Convenience

- EasyLink (HDMI-CEC): Audio Return Channel, Automatic audio input mapping, Remote Control-Passthrough
- HDMI Features: Audio Return Channel (ARC), Content Type, Support 4K2K

### Power

- Power supply: 110-240V, 50Hz
- Standby power consumption: <0.5 W

### Dimensions

- Subwoofer (W x H x D): 195X304X400 mm
- Main Unit (W x H x D): 1060X38X54.5 mm

### Accessories

- Included accessories: 2 x AAA Batteries, Power cord, Remote Control, Safety & Legal Leaflet, Trademarks Sheet, User Manual, World Wide Warranty leaflet, Wall mount bracket

### Design

- Wall mountable

### Outer Carton

- EAN: 48 95185 60678 1
- Gross weight: 13,73 kg
- Outer carton (L x W x H): 112 x 35,5 x 35 cm
- Nett weight: 8,63 kg
- Number of consumer packagings: 1
- Tare weight: 5,10 kg

### Packaging dimensions

- Packaging dimensions (W x H x D): 112 x 35 x 35,5 cm
- EAN: 48 95185 60678 1
- Gross weight: 13,73 kg
- Nett weight: 8,63 kg
- Number of products included: 1
- Packaging type: Dummy
- Tare weight: 5,10 kg
- Type of shelf placement: Dummy

### Product dimensions

- Product dimensions (W x H x D): 106 x 3,8 x 5,5 cm
- Weight: 1,5 kg



Issue date 2016-05-17

Version: 3.4.7

12 NC: 8670 001 23464  
EAN: 48 95185 60678 1

© 2016 Koninklijke Philips N.V.  
All Rights reserved.

Specifications are subject to change without notice.  
Trademarks are the property of Koninklijke Philips N.V.  
or their respective owners.

[www.philips.com](http://www.philips.com)